

**INSET**

1

2

3

4

5

6

7

8

9

10

11

12

13

14

UPDATES BY  
CHRISTINE CHAMBERLAIN  
MAPPING

THESE MAPS ARE FOR ASSESSMENT PURPOSES ONLY. THEY ARE NOT TO BE USED FOR DESCRIPTION, CONVEYANCE, OR DETERMINATION OF LEGAL TITLE. ALL INFORMATION IS SUBJECT TO CHANGE.

1:20,000

TOWN OF  
**BRIDPORT**  
VERMONT  
UPDATED THROUGH APRIL 1, 2022

**INDEX**

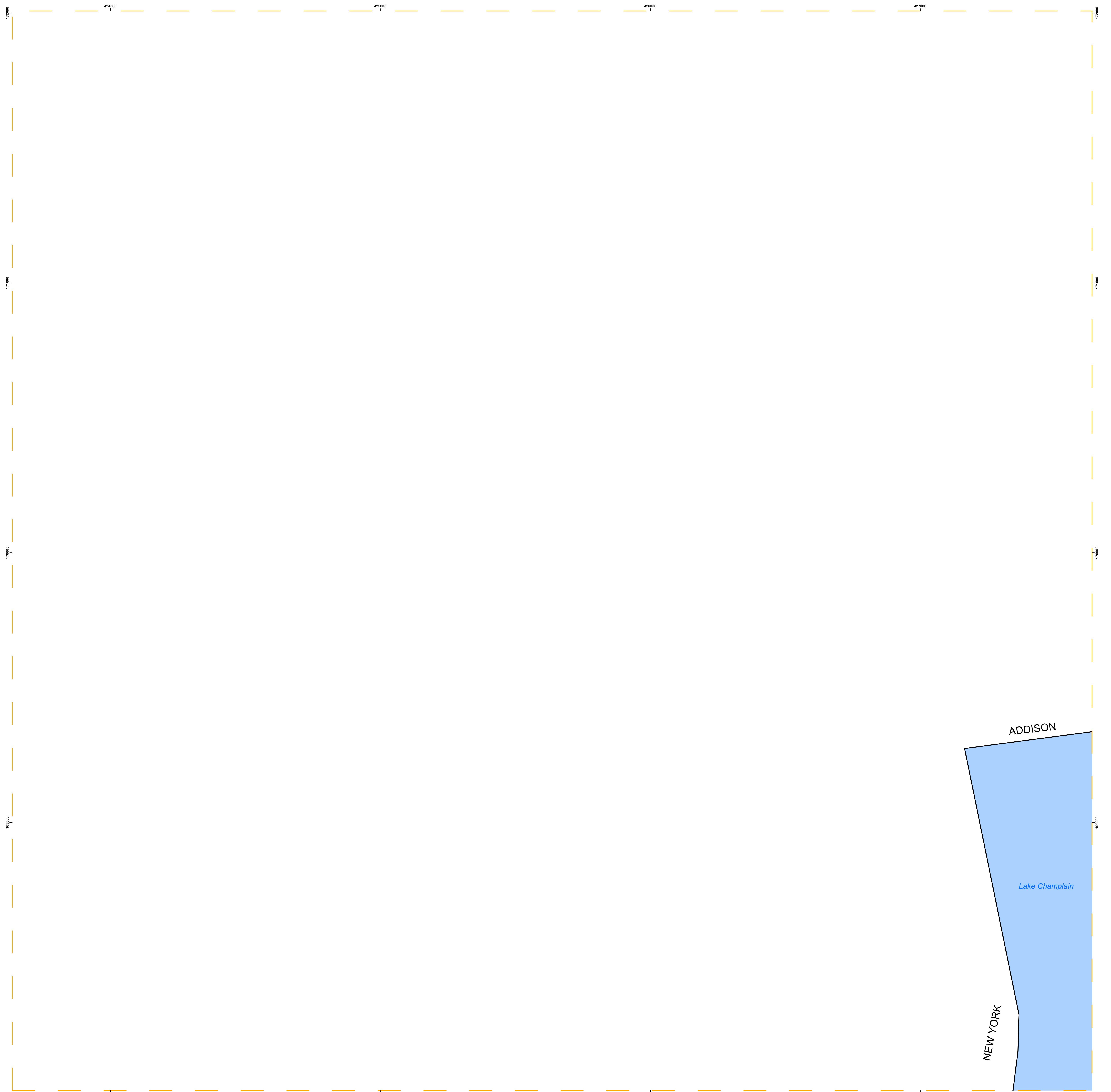
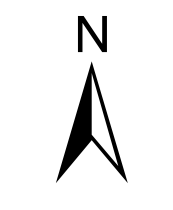

UPDATES BY  
**CHRISTINE CHAMBERLAIN**  
MAPPING

THESE MAPS ARE FOR ASSESSMENT PURPOSES ONLY. THEY ARE NOT TO BE USED FOR DESCRIPTION, CONVEYANCE, OR DETERMINATION OF LEGAL TITLE. ALL INFORMATION IS SUBJECT TO CHANGE.

<b>Legend</b>	State boundary	Right-of-Way	<b>Zoning Adopted 2006</b>	Shoreland Planned Residential District	<b>26</b> Parcel number (10.2AcS) Subparcel acres
	Town boundary	Common Ownership	Residential Agricultural District	Village District	<b>(22)</b> Subparcel number (1) Subdivision lot number
	Road boundary	Unlanded Property	Residential District	Neighborhood Commercial District	<b>(19)</b> Historical parcel number 06-086 Parcel number from adjoining sheet
	Parcel boundary	Surface water	Conservation District	26 Parcel number not in grand list	10Ac Acres
	Subparcel boundary	Match line			10AcS Acres surveyed
Water boundary				10AcC Acres calculated	430000 State plane coordinates

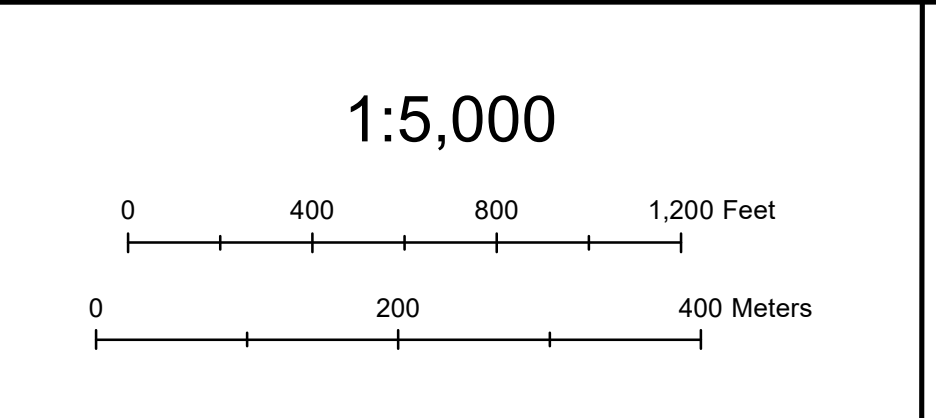

TOWN OF  
**BRIDPORT**  
VERMONT  
UPDATED THROUGH APRIL 1, 2022

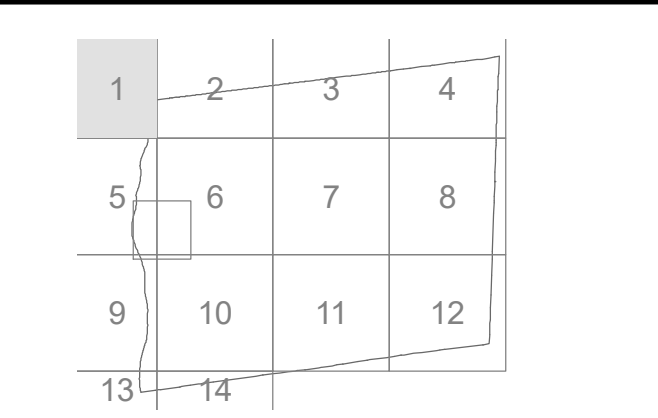

LOCAL MAP NO.  
**1**  
VERMONT SHEET 76168



Index

MAPID	NAME
02-001	HUTCHINSON GARY
02-003	GIBNEY DOUGLAS E & DONNA E
02-004	DARLING 2021 JOINT TRUST - LIFE ESTATE
02-006	
02-008	BLASIUS JOSEPH E JR & GAIL T
02-009	SHAPIRO JAY
02-010	BLANCHARD WILLIAM & VALENCIA
02-011	LOWTHER CONRAD
02-012	BANK OF NEW YORK MELLON AS TRUSTEE
02-013	DAIGLE RICHARD J
02-014	GEFERS THOMAS
02-014.1A	MARCUS JOHN
02-014.2A	HANSON JOHN E & ANN CRAIG TRUST
02-015	SAPIR DONALD L & JANET
02-016.1	DUFFY PETER
02-016.2	CAI XIAOLONG
02-016.A	MANEELY BRADLEY E
02-017	HANCOX FAMILY TRUST
02-018.A	SHEETS MICHAEL & SUSAN
02-019	MCALIFFE KEVIN &
02-020	MILLER PAUL W III & CONSTANCE S
02-021	MILLER LAKE LLC
02-022	CUTLER STEPHEN & KARAN D
02-023	SPRAGUE JASON L
02-024.A	RESENDES MERILDA - LIFE ESTATE
02-025	TRIPLE E FARMS LLC-1
02-025.1	BERUBE FRANCIS X & PAMELA J
02-026	MARSHALL JUNIPER A
02-026.12	PROVENCHE ARTHUR G 2009 TRUST
02-026.13	WCNE PROPERTIES LLC
02-026.2	ROY ROGER J & JEANNINE M - LIFE ESTATE
02-026.3A	KARTHAUS NICOLAAS P & LOUISE E
02-026.4	OLSON/DOMKE JOINT REVOCABLE TRUST
02-026.5	STONE JUSTIN G
02-026.6	CHARBONEAU JERRY
02-026.7	KAUFMANN BRANDT T
02-026.8	MOONEY RAYMOND P
02-027.3	FIELDS CHARLES
02-028	
02-029	L'HEUREUX CRAIG R LIFE ESTATE
02-030	HASTINGS KENNETH -1
02-032	ELLISON JEFFREY B
02-033	GOEKE RICHARD J
02-034	K & M REALTY TRUST
02-035.A	HUESTIS ROBERT C & DAVID F & WILLIAM L
02-038.4	COLLETTE DONALD
02-038.5	GRAVES BRUCE - LIFE ESTATE
02-038.6	BICKNELL PAUL
03-030	DYKEMA RAYMOND S
06-085	KOLLER STEPHEN & SHARON
06-086.A	KOLLER SHARON N 2008 TRUST

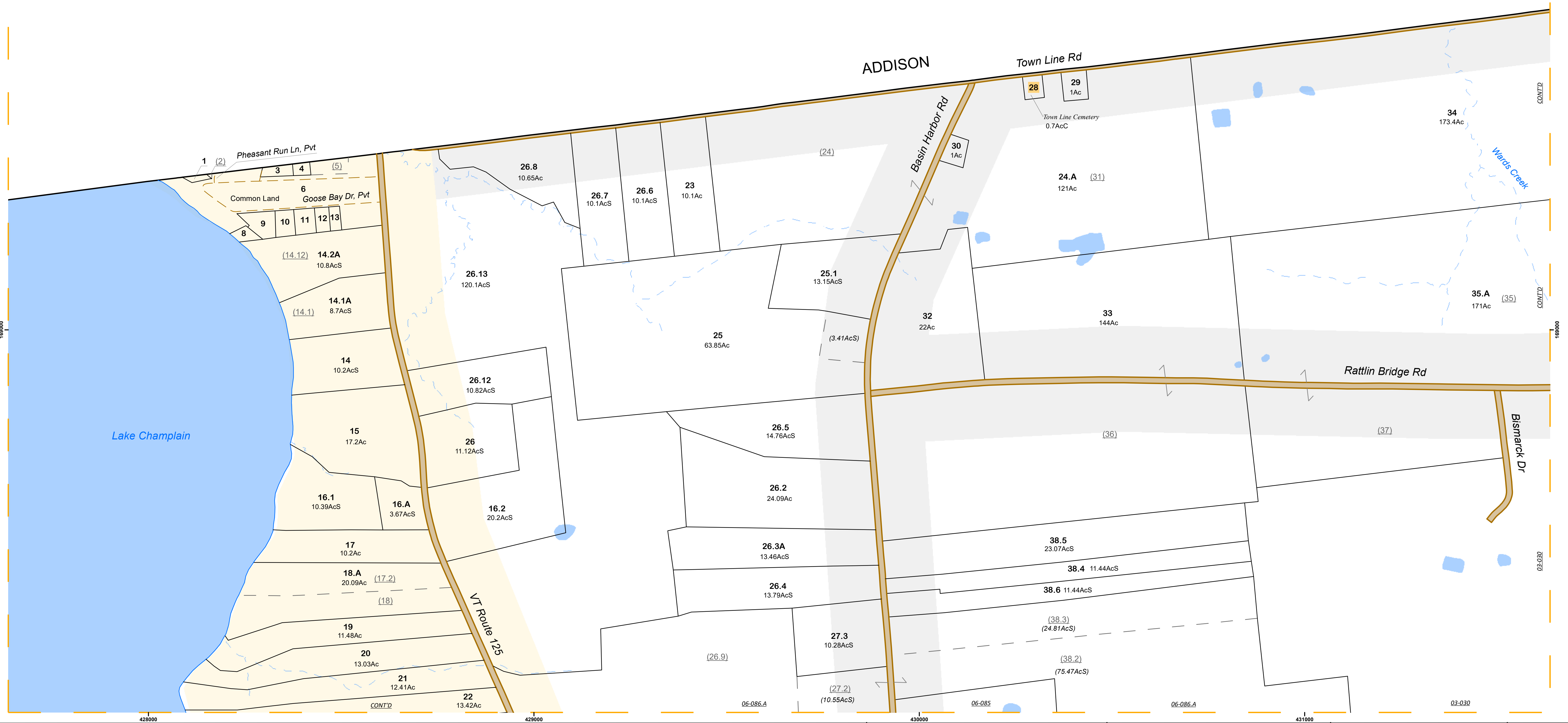

UPDATES BY  
**CHRISTINE CHAMBERLAIN**  
MAPPING

THESE MAPS ARE FOR ASSESSMENT PURPOSES ONLY. THEY ARE NOT TO BE USED FOR DESCRIPTION, CONVEYANCE, OR DETERMINATION OF LEGAL TITLE. ALL INFORMATION IS SUBJECT TO CHANGE.

<b>Legend</b>	<ul style="list-style-type: none"> <li>State boundary</li> <li>Town boundary</li> <li>Road boundary</li> <li>Parcel boundary</li> <li>Subparcel boundary</li> <li>Water boundary</li> <li>Right-of-Way</li> <li>Common Ownership</li> <li>Unlanded Property</li> <li>Surface water</li> <li>Match line</li> </ul>	<p><b>Zoning Adopted 2006</b></p> <ul style="list-style-type: none"> <li>Shoreland Planned Residential District</li> <li>Village District</li> <li>Residential Agricultural District</li> <li>Residential District</li> <li>Conservation District</li> <li>Neighborhood Commercial District</li> </ul>	<p>26 Parcel number (10.2AcS) Subparcel acres</p> <p>(22) Subparcel number (1) Subdivision lot number</p> <p>(19) Historical parcel number 06-086 Parcel number not in grand list</p> <p>10Ac Acres surveyed</p> <p>10AcS Acres calculated</p> <p>43000 State plane coordinates</p>
---------------	---	--	---

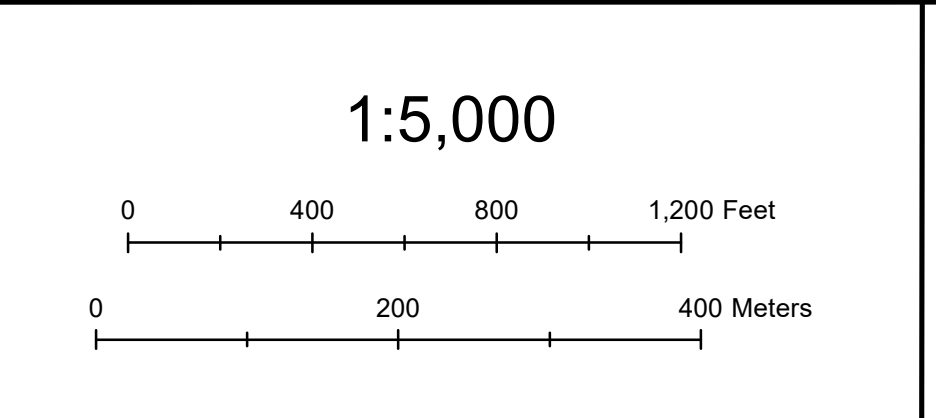

TOWN OF  
**BRIDPORT**  
VERMONT

UPDATED THROUGH APRIL 1, 2022

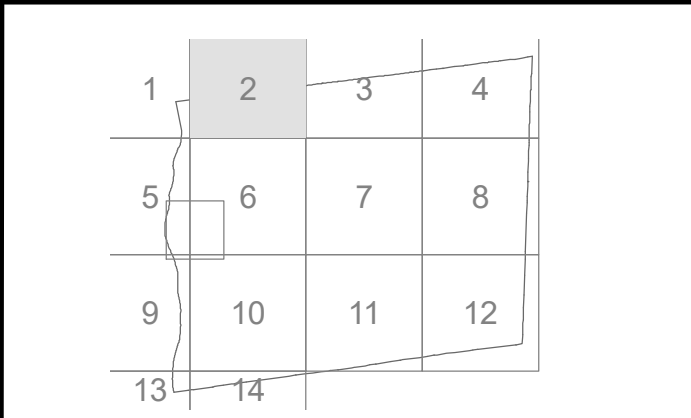

LOCAL MAP NO.  
**2**

VERMONT SHEET 80168



**Index**

MAPID	NAME
02-034	K & M REALTY TRUST
02-035.A	HUESTIS ROBERT C & DAVID F & WILLIAM L
03-001	JACKMAN TERRY L
03-001.2	BOULANGER ANTHONY
03-002	ROTHWELL CATHERINE I
03-002.1	BERTHIAUME DAVID B
03-003	CLAWSON INA IO
03-004	GORDON CHRISTOPHER & TRICIA
03-004.1	BAILEY NELSON & MONICA
03-005	DWY CHRISTINE J
03-007	BLUE SPRUCE FARM INC-5
03-008	FOSHAY LESLIE & JENNIFER
03-009	TRIPLE E FARMS LLC-2
03-009.1	CLARK DANNY P
03-009.2	HOLMES ROBERT D
03-009.3	TRIPLE E FARMS LLC-3
03-010	GIPSON DAVID & LOUELLA
03-011	CRAIG JAMES A SR
03-012	DUFFANY REVOCABLE TRUST UTA APRIL 10,20
03-013	GREELEY ROBERT W B
03-014	FOSHAY LESLIE R & JENNIFER S
03-015	PIPER DENNIS & JANET
03-016.A	TRIPLE E FARMS LLC-4
03-017	BROUILLARD GERARD & CONNIE - LIFE ESTATE
03-018	ADDIS JESSICA L
03-019	BROUILLARD ALBERT
03-020	TALLEN DAVID N
03-022	PRICE KOZIC SARAH JANE
03-024	HUBER DANIEL
03-025	GRANT JORDAN G
03-025.1	PROVENCHER MONTE E & DONNA M
03-026	RUFFA JOHN & JILL
03-027	SANDERS BRIAN
03-028	RANDALL STEPHEN
03-029	RANNEY JOSHUA & NICOLE
03-029.4	PHILLIPS ANTHONY J
03-029.41	COMEAU ZACHARY A
03-030	DYKEMA RAYMOND S
03-031	SUMNER RICKEY & DAWN
03-032	BOUDREAU ALBERT HENRY
03-032.1	SIMMONS BRADFORD R
03-035.1	TRIPLE E FARMS LLC-5
03-035.2	INGVERSEN CATHERINE S
03-036	GIARD STEVEN & MICHELLE
03-037	PLOUFFE GERARD ALDEE
03-038	MANY MONTE A
03-039.1	BORDELEAU PIERRE M & HEIDI L
03-039.11	BORDELEAU MICHAEL & LYNN
03-039.2	ADDISON COUNTY COMMUNITY TRUST

MAPID	NAME
03-039.4	BORDELEAU ANDRE
03-041	CURTIS CADEN
03-043	VT DEPT OF FISH & WILDLIFE
03-043.A	VT DEPT OF FISH & WILDLIFE
03-044	BLUE SPRUCE FARM INC-4
03-047	BARNES CHARLOTTE P FAMILY TRUST
03-048	JOHNSON JONATHAN
03-049.A	TRIPLE E FARMS LLC-6
03-050	DUNBAR KLANCY S
03-051	BARNES JASON R & REBECCA B
03-052.B	PAQUETTE EMILE & ELAINE
04-003	ZELIFF ROBERT & PATRICIA
04-005.A	TRIPLE E FARMS LLC-7
04-074	DESFORGES BRIAN & ELAINE A
07-001	BORDELEAU MICHAEL V & LYNN-2
07-018.A	BLUE SPRUCE FARM INC-3
Unlanded	
03-016.SOL	TERRAFORM SOLAR XVII LLC
03-039.2B	MOULTON LINDA



UPDATES BY  
**CHRISTINE CHAMBERLAIN  
MAPPING**

THESE MAPS ARE FOR ASSESSMENT PURPOSES ONLY. THEY ARE NOT TO BE USED FOR DESCRIPTION, CONVEYANCE, OR DETERMINATION OF LEGAL TITLE. ALL INFORMATION IS SUBJECT TO CHANGE.

**Legend**

- State boundary
- Town boundary
- Road boundary
- Parcel boundary
- Subparcel boundary
- Water boundary
- Right-of-Way
- Common Ownership
- Unlanded Property
- Surface water
- Match line

**Zoning Adopted 2006**

- Residential Agricultural District
- Residential District
- Conservation District
- Shoreland Planned Residential District
- Village District
- Neighborhood Commercial District

**26** Parcel number (10.2AcS) Subparcel acres  
**(22)** Subparcel number (1) Subdivision lot number  
**(19)** Historical parcel number 06-086 Parcel number from adjoining sheet  
**10AcS** Acres  
**10AcS** Acres surveyed  
**10AcC** Acres calculated

43000 State plane coordinates

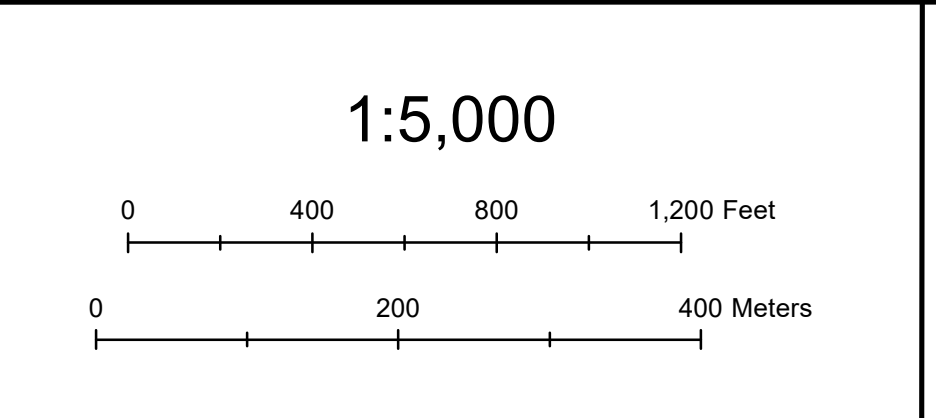

TOWN OF  
**BRIDPORT**  
VERMONT  
UPDATED THROUGH APRIL 1, 2022

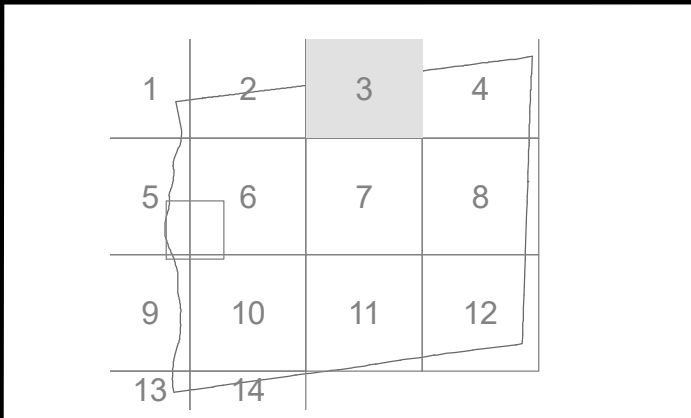

LOCAL MAP NO.  
**3**  
VERMONT SHEET 84168



**Index**

MAPID	NAME
03-016.A	TRIPLE E FARMS LLC-4
03-025.1	PROVENCHER MONTE E & DONNA M
03-028	RANDALL STEPHEN
03-029	RANNEY JOSHUA & NICOLE
03-029.41	COMEAU ZACHARY A
03-050	DUNBAR KLANCY S
04-002	CARL MATTHEW A
04-003	ZELIFF ROBERT & PATRICIA
04-004	BAHNCK KEVIN B
04-005.A	TRIPLE E FARMS LLC-7
04-006	KRAWCZYK CAROL
04-007.A	DUVIC CHARLES
04-007.B	SHEETS LEANN P
04-007.C	BLUJE SPRUCE FARM INC
04-010	GOREAU PETER D & CLARE WILMONT LE
04-011	CONARD NATHANIEL E
04-012	KIRBY PATTI R
04-013	PAQUETTE MARY M
04-014	HASTINGS KENNETH -2
04-015	SANDBERG BRADLEY
04-016.A	WARNER N. THOMAS & SABRINA
04-017	LEWIS DEBORAH J
04-018	CARTLAND ELIZABETH
04-019.1	ROSEN DAVID REVOCABLE TRUST
04-020	HANLY PETER
04-020.2	DODDS JEREMY J & KATHERINE E
04-021	BROUGHTON CODY S
04-021.A	FORBES JERRY R

MAPID	NAME
04-022	NOVOSEL GARY T
04-023	LAVALLA JORDAN K
04-024	KENNISON GREGORY, DOROTHY & DAVID
04-025	GOODALE MICHAEL K & HEATHER E
04-026	CANNON JOHN D
04-026.1	MANEGOLD CATHERINE S 2012 LIVING TRUST
04-027	THORPE LARRY R - LIFE ESTATE
04-028.1	FOOTE RICHARD P & CARSON W
04-028.11	HARRIS EDMUND, HOPKINSON ANNE &
04-028.2	SHEPPARD BECKY Y
04-028.3	WHITLEY PATRICK
04-028.4	CYR ROBERT & JEANNETTE
04-028.5	MUZACA LOUISE R LIFE ESTATE
04-029	MACK ELLYN
04-030	BRET PROPERTIES LLC
04-031	CARL WINSTON & LOUISE LIFE ESTATE
04-032	PELLERIN BRIAN S & REBECCA L J
04-033	GLEASON BENJAMIN H & THERESA CHANCE
04-034	WITSCHER JESSIE B
04-035	ROBERTS JENNIFER L
04-036	TUBLITZ DANIEL E & LINDA J TRUSTEES
04-037	KIMBERLY RAMSDALL
04-042	RAUNCKER SARAH
04-043.1	MCDERMOTT WARREN PATRICK
04-044	BIXBY SUZANNE LIFE ESTATE
04-045.A	WHEELER J. DREXEL
04-047	ROELFFS CHRISTOPHER J
04-048	MITCHAM EDWARD H JR TRUST
04-049	BETOURNEY KEITH & KIMBERLY
04-050	MYRICK ANNE MARY

MAPID	NAME
04-051	LIZOTTE JANET
04-052	HODGDON KATHLEEN M LIFE ESTATE
04-053	LATREILLE PRISCILLA - LIFE ESTATE
04-054	MCLEAN DAVID A & ANN M - LIFE ESTATE
04-055	MAXWELL TOM G JR & NANCY
04-056	ZIMNY SUSAN T - LIFE ESTATE
04-057	GEER CLAIRE
04-058	PETERSON WILLIAM & SANDRA
04-059	BARRETT MICHAEL
04-060	PEGRAM ROBERT B
04-061	RYAN SUSAN LIFE ESTATE
04-062	GIRARD DAVID
04-063	FINNERTY FRANCIS
04-064	LIMOGGE PHILIP L
04-065	BARRETT SUSAN E
04-067	SHERMAN RUSSELL R
04-068.A	PAYNE GARY
04-069	BERGEBIN BERNARD
04-070	NATURE CONSERVANCY
04-071.1	ANDERSON TIMOTHY B & SUSAN M
04-071.2	GOODSPEED JOHN & LINDA
04-071.3	LAFOUNTAIN TRAVIS JAMES
04-072	LAFOUNTAIN MADELYN
04-074	DESFORGES BRIAN & ELAINE A
07-018.A	BLUE SPRUCE FARM INC-3
08-003	MARKUT THEODORE A.
08-010	PAYNE CHARLES
08-030	ELITHORPE BRIAN J & NICOLE L

MAPID	NAME
Unlanded	
04-071.2B	CURLER MARK & ANDREA
04-071.3B	LAFOUNTAIN TRAVIS

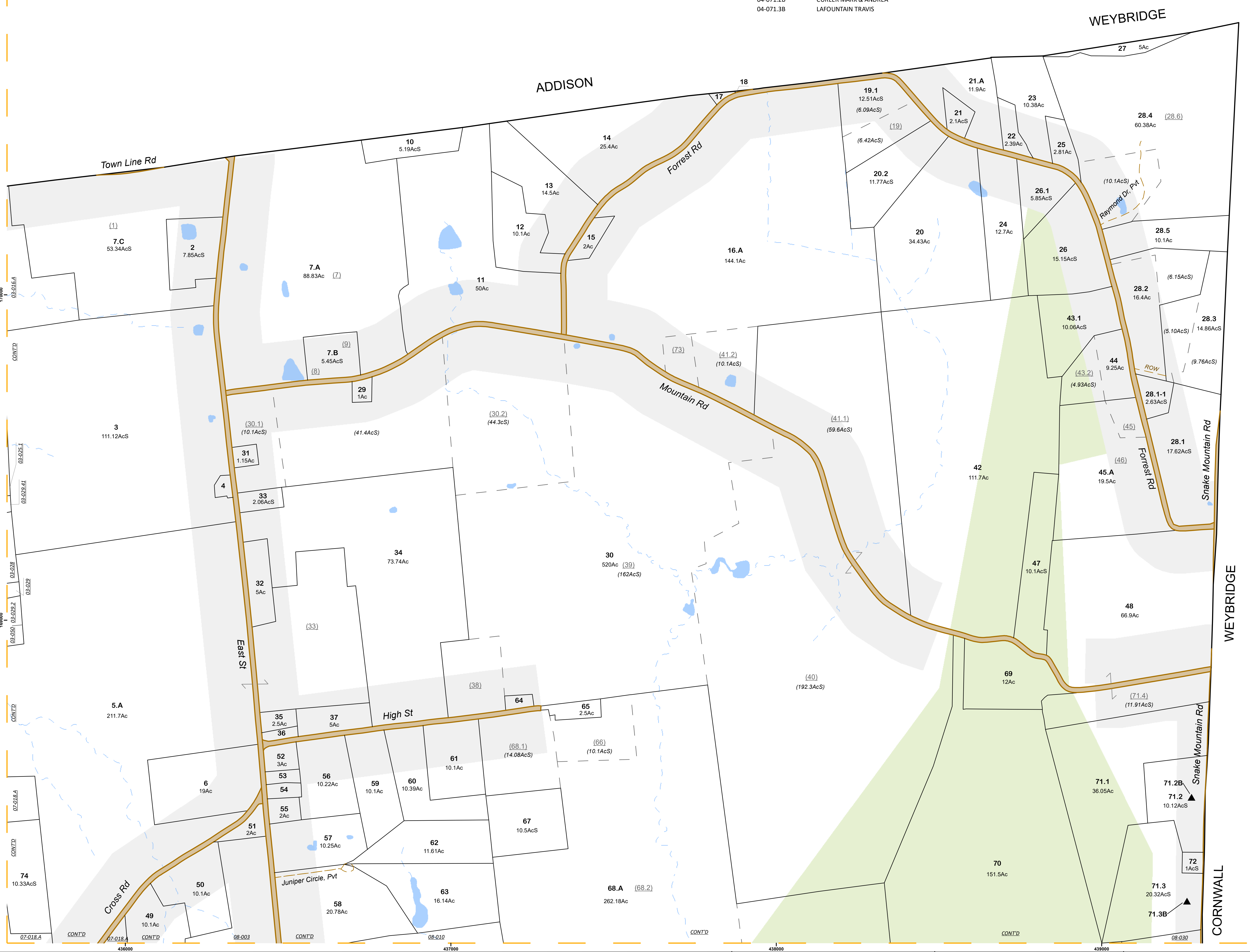

UPDATES BY  
**CHRISTINE CHAMBERLAIN  
MAPPING**

THESE MAPS ARE FOR ASSESSMENT PURPOSES ONLY. THEY ARE NOT TO BE USED FOR DESCRIPTION, CONVEYANCE, OR DETERMINATION OF LEGAL TITLE. ALL INFORMATION IS SUBJECT TO CHANGE.

**Legend**

State boundary	Right-of-Way	<b>Zoning Adopted 2006</b>	Shoreland Planned Residential District	<b>26</b> Parcel number (10.2AcS) Subparcel acres
Town boundary	Common Ownership	Residential Agricultural District	Village District	<b>(22)</b> Subparcel number (1) Subdivision lot number
Road boundary	Unlanded Property	Residential District	Neighborhood Commercial District	<b>(19)</b> Historical parcel number 06-086 Parcel number from adjoining sheet
Parcel boundary	Surface water	Conservation District	Match line	<b>26</b> Parcel number not in grand list
Subparcel boundary	Water boundary			43000 State plane coordinates
				10AcS Acres surveyed
				10AcC Acres calculated

**1:5,000**

0 400 800 1,200 Feet

0 200 400 Meters

TOWN OF  
**BRIDPORT**  
VERMONT

UPDATED THROUGH APRIL 1, 2022

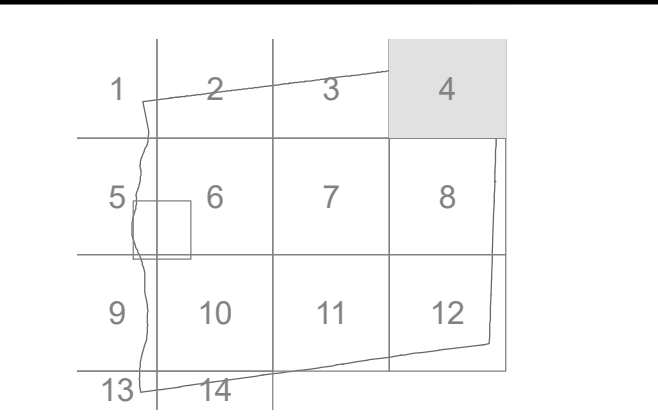

LOCAL MAP NO.  
**4**

VERMONT SHEET 88168

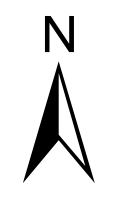

**Index**

MAPID	NAME
05-001	PAQUET CYNTHIA
05-002	COMO JOHN
06-004.A	CHAMPLAINSIDE PROPERTIES LLC
06-018.2	HOWLETT THOMAS C
10-001.A	DESAUTELS ANDRE

UPDATES BY  
**CHRISTINE CHAMBERLAIN  
MAPPING**

THESE MAPS ARE FOR ASSESSMENT PURPOSES ONLY. THEY ARE NOT TO BE USED FOR DESCRIPTION, CONVEYANCE, OR DETERMINATION OF LEGAL TITLE. ALL INFORMATION IS SUBJECT TO CHANGE.

**Legend**

State boundary	Right-of-Way	<b>Zoning Adopted 2006</b>	Shoreland Planned Residential District	<b>26</b> Parcel number (10.2AcS) Subparcel acres	Parcel number	(1) Subdivision lot number
Town boundary	Common Ownership	Residential Agricultural District	Village District	<b>(22)</b> Subparcel number (1)	Historical parcel number	06-086 Parcel number from adjoining sheet
Road boundary	Unlanded Property	Residential District	Neighborhood Commercial District	<b>(19)</b> Acres surveyed	Acres surveyed	43000 State plane coordinates
Parcel boundary	Surface water	Conservation District		<b>10Ac</b> Acres calculated	Acres calculated	
Subparcel boundary	Match line					
Water boundary						

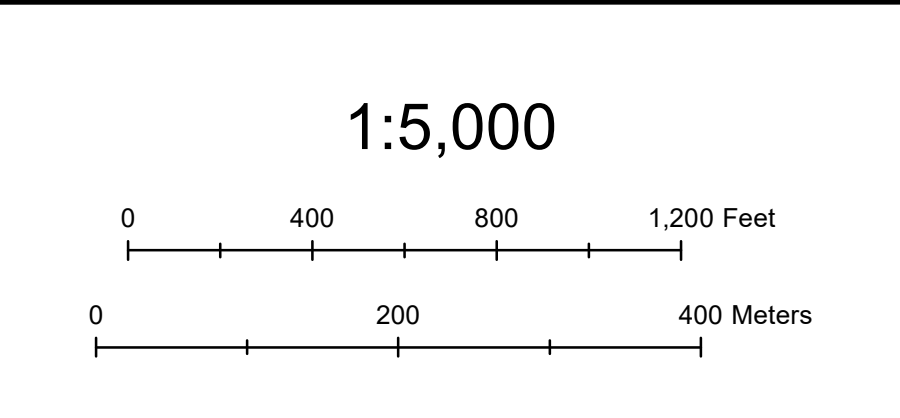

TOWN OF  
**BRIDPORT**  
VERMONT

UPDATED THROUGH APRIL 1, 2022

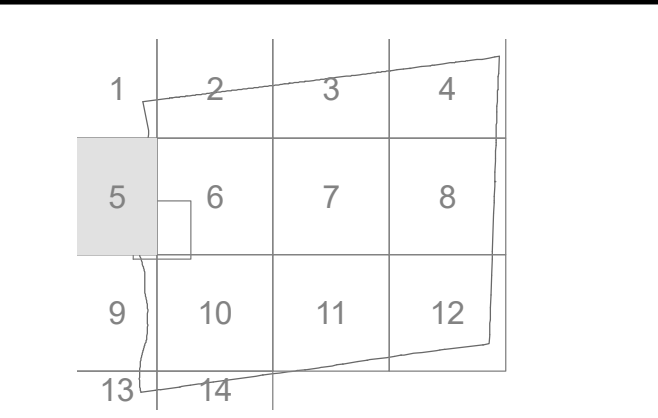

LOCAL MAP NO.  
**5**

VERMONT SHEET 76164

## Index

MAPID	NAME
02-022	CUTLER STEPHEN & KARAN D
03-030	DYKEMA RAYMOND S
06-001	FONTES MICHAEL & DEBORAH
06-002	KAMIS JOANNA P
06-003	MORGAN ELLIOT R
06-004.A	CHAMPLAINSIDE PROPERTIES LLC
06-006	WELCH PAULINE-2
06-007.A	CONNOR MARIAN FAMILY TRUST
06-011.2	LEE ALEXANDRA R
06-011.3	STOCKER BRUCE H
06-011.A	WELCH PAULINE-1
06-011.B	STOCKER KEVIN
06-012.2	WELCH FRANCIS
06-013	RIORDAN BENJAMIN
06-014	ROORDA SIDNEY & GEZIENA B
06-015	BAHNCK JEFFREY B & ALETHEA J
06-017	HOWLETT TIMOTHY W & JULIE A
06-018.2	HOWLETT THOMAS C
06-020	HOWLETT STEPHEN REVOCABLE TRUST, TRUSTEE
06-022.A	PYLE MICHAEL L & JULIE L
06-023	
06-025	MANNING ANDREW-1
06-026.A	BLISSFUL DAIRY LLC
06-027.A	HUESTIS REBECCA
06-028	HUESTIS CLIFFORD & ANITA
06-029	ANDERSON LEE A SR
06-030.A	HUESTIS ROBERT C & DAVID F & WILLIAM L
06-031.A	HUESTIS ARTHUR & JOAN-2
06-033	CHAMPLAINSIDE PROPERTIES LLC
06-034	HUESTIS JOAN R & CLAIRE E
06-036	
06-037	BEAROR /MCCRACKEN REVOCABLE TRUST
06-039	DECOTIS JOHN J
06-040	PYLE MICHAEL L & JULIE L
06-083	GOODRICH CHRISTOPHER & DEBORAH
06-084	NORRIS STEPHEN
06-085	KOLLER STEPHEN & SHARON
06-086.A	KOLLER SHARON N 2008 TRUST
07-041	HUESTIS JOAN
07-042	WATERMAN ROBERT & LINDA-1
10-001.A	DESAUTELS ANDRE
11-001	TIMUR FARMS INC.
Unlanded	
06-034.B	PYLE MICHAEL & JULIE



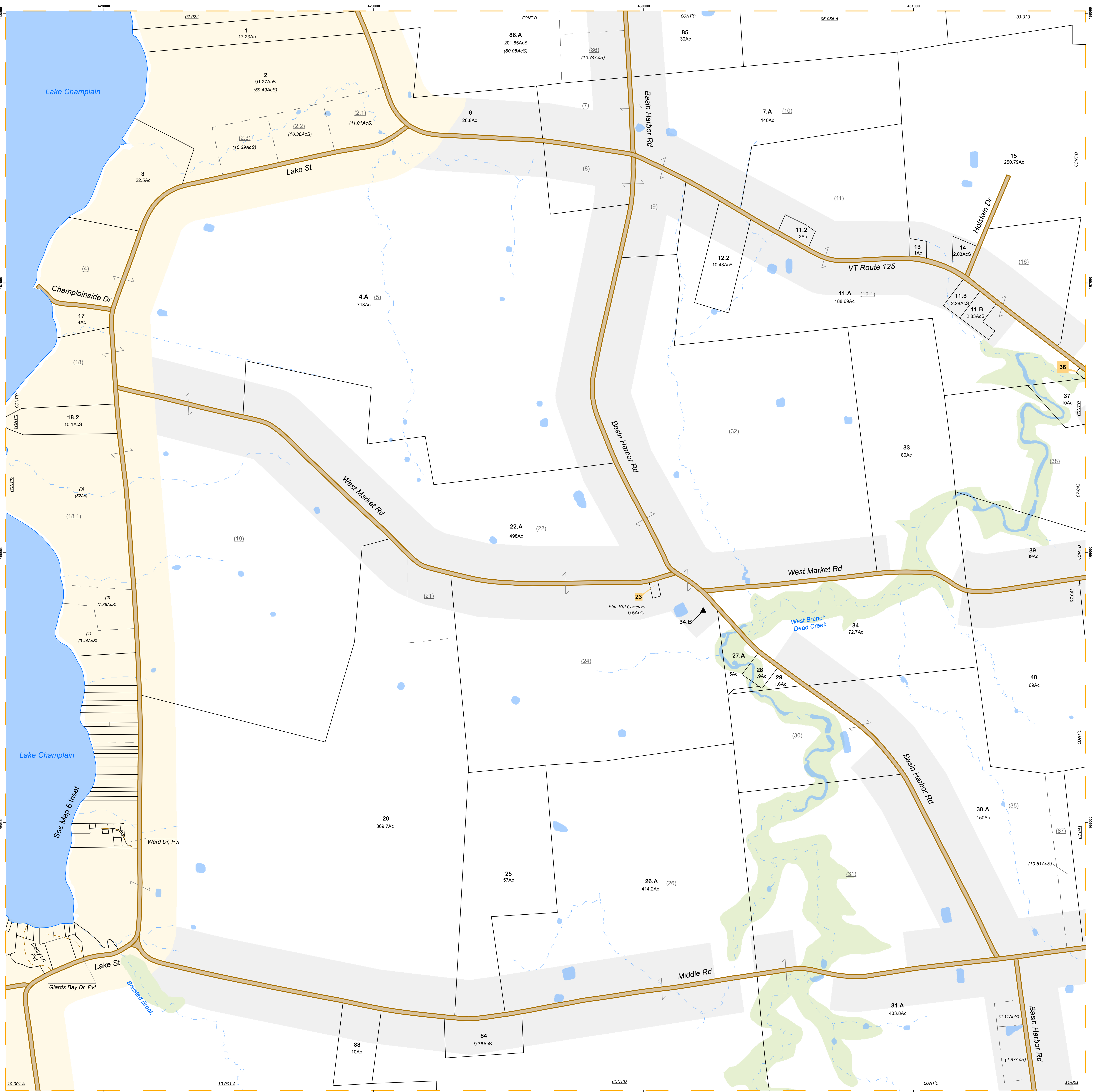
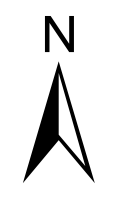

UPDATES BY  
**CHRISTINE CHAMBERLAIN**  
MAPPING

THESE MAPS ARE FOR ASSESSMENT PURPOSES ONLY. THEY ARE NOT TO BE USED FOR DESCRIPTION, CONVEYANCE, OR DETERMINATION OF LEGAL TITLE. ALL INFORMATION IS SUBJECT TO CHANGE.

**Legend**

— State boundary	— Right-of-Way	<b>Zoning Adopted 2006</b>	Shoreland Planned Residential District	<b>26</b> Parcel number (10.2AcS) Subparcel acres	Parcel number (10.2AcS) Subparcel acres
— Town boundary	— Common Ownership	Residential Agricultural District	Village District	<b>(22)</b> Subparcel number (1) Subdivision lot number	Subparcel number (1) Subdivision lot number
— Road boundary	▲ Unlanded Property	Residential District	Neighborhood Commercial District	<b>(19)</b> Historical parcel number	Historical parcel number
— Parcel boundary	■ Surface water	Conservation District		10AcS Acres surveyed	06.086 Acres surveyed
- - Subparcel boundary	— Match line			10AcC Acres calculated	26 Parcel number not in grand list
— Water boundary				43000 State plane coordinates	43000 State plane coordinates

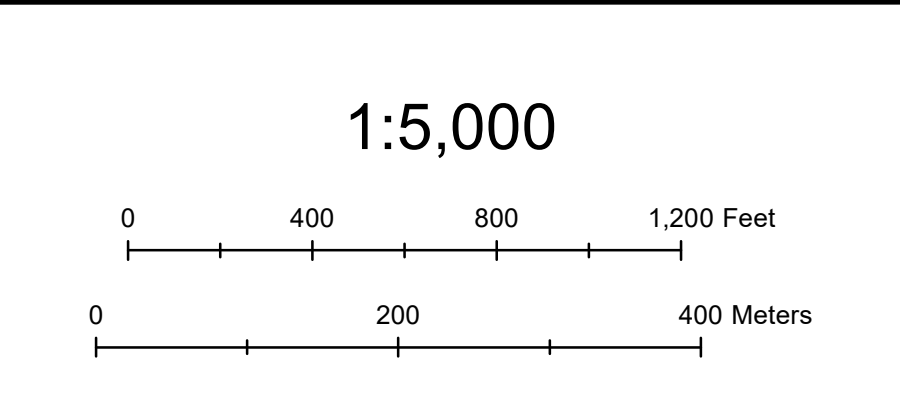

TOWN OF  
**BRIDPORT**  
VERMONT  
UPDATED THROUGH APRIL 1, 2022

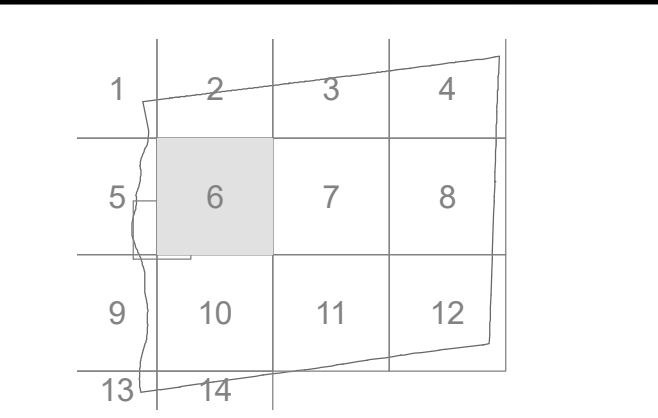

LOCAL MAP NO.  
**6**  
VERMONT SHEET 80164

Index

MAPID	NAME	MAPID	NAME
03-030	DYKEMA RAYMOND S	07-117	SULLIVAN JENNIFER R
03-035.1	TRIPLE E FARMS LLC-5	07-118	GABORIAULT CLEMENT & JOYCE-1
03-043	VT DEPT OF FISH & WILDLIFE	07-119	TOWN OF BRIDPORT
03-043.A	VT DEPT OF FISH & WILDLIFE	07-120	RINEY JOSHUA R
03-049.A	TRIPLE E FARMS LLC-6	07-122	JRB VENTURES LLC
06-015	BAHNCK JEFFREY B & ALETHEA J	07-123	BRIDPORT GRANGE
06-036		07-124	OLIVER H DEXTER & RUTH
06-037	BEAROR /MCCRACKEN REVOCABLE TRUST	07-125	GIARD HELEN, ESTATE OF
06-039	DECOTIS JOHN J	07-126	MANNING ANDREW-2
06-040	PYLE MICHAEL L & JULIE L	07-127	BRIDPORT HISTORICAL SOCIETY
07-001	BORDELEAU MICHAEL V & LYNN-2	07-128	SMITH ELIZABETH F
07-002	KENYON PAUL	07-129	OLIVER EMMA
07-003	CONNOR MARIAN FAMILY TRUST	07-130	MADELIA LLC
07-004	BARNES KATHERINE	07-131	WAITSFIELD & CHAMPLAIN VALLEY TELECOM
07-004.2	DUCLOS MICHAEL & MERRY	07-132	BROUGHTON FARM SUPPLY INC
07-004.3	BEAROR DAVID-2	07-134.2	HOTTE LUKE FAMILY TRUST
07-005	WOLOHOJIAN JAMES H	07-134.3	HOTTE TIMOTHY
07-006	BLUE SPRUCE FARM INC-1	08-006	CRUM ELIZABETH C & DARBY L
07-007	LAROCQUE ISAAC M	08-007.A	LONG CLOUD FARM LLC
07-008	LONG CLOUD FARM LLC	08-040.2	TAYLOR LISA
07-009	ROBERTSHAW DANIEL B	08-042	BROUGHTON ADAM P
07-010	WATERMAN ROBERT & LINDA-2	11-001	TIMUR FARMS INC
07-015	WALKER REVOCABLE LIVING TRUST	11-004	GILE RONALD & CAROL
07-017	RYAN KEVIN P	11-006.A	SUHR WILLIAM F
07-018.A	BLUE SPRUCE FARM INC-3	11-024.2	RYKS BRIAN J
07-019	WALKER REVOCABLE LIVING TRUST	11-024.3	GIARD DORIS M
07-021	WALKER REVOCABLE LIVING TRUST	11-071	DUDDLES CRAIG W
07-022	CONNOR KELLEY J.	Unlanded	
07-022.1	SHAW FARM INC-1	06-039.MH	CONNOR LEO J
07-023	DELPHIA EVERETT & RITA - LIFE ESTATE	07-022.SOL	KENDALL SUSTAINABLE INFRASTRUCTURE
07-024	PRATT'S STORE INC	07-050	BROUGHTON MATTHEW
07-025	BOUDREAU DANIEL P & ELIZABETH A	07-118.B	GABORIAULT JOYCE
07-027	WALKER REVOCABLE LIVING TRUST		
07-027.2	TOWN OF BRIDPORT		
07-029	STORO CHARLES C & PATRICIA A		
07-030	GODARD TIMOTHY & AMY		
07-031	WALKER REVOCABLE LIVING TRUST		
07-033	GUENDEL PETER H		
07-034	O'CONNELL FRANCES		
07-038	JT'S REAL ESTATE INVESTMENTS LLC		
07-039	MURRAY RONALD H & BONNIE B		
07-040	WILLEY FAMILY TRUST UTA AUG 29, 2019		
07-041	HUESTIS JOAN		
07-042	WATERMAN ROBERT & LINDA-1		
07-043	VORSTEVELD ANDRE		
07-045	BUSBY JUSTIN & LISA SHAFFER		
07-046.A	BLISSFUL DAIRY LLC		
07-047	TRIPLE E FARMS LLC-8		
07-048	WALKER WILLIAM M		
07-049	CONNOR LEO JR & CHERYL-3		
07-049.1	DECARLO STEVEN		
07-049.2	CARL CHRISTOPHER & REBECCA		
07-051	BROUGHTON THOMAS M & CHARLENE N - LIFE E		
07-052	COLLINS CATHY M		
07-053	JRB VENTURES LLC		
07-054	PHILLIPS RICHARD J 2014 TRUST		
07-055			
07-056	MULLIKIN ELIZABETH		
07-057	SNYDER MONA L		
07-058	BECKER JEFFREY & MICHELLE		
07-059	BOIE ROBERT		
07-060	CLARK ROBERT		
07-061.A	MYRICK ROBERT L. SR FAMILY TRUST		
07-061.B	MYRICK JR STEPHEN A		
07-061.C	DIXON SAMUEL		
07-063.1	DECOFF MATTHEW T		
07-064.A	HUESTIS ARTHUR & JOAN-1		
07-065	PRATT COREY & LAURIE A		
07-066	GILBERT DANA J		
07-067	BRIDPORT CONGREGATIONAL CHURCH RECTORY		
07-068	KORETZ DEBRA		
07-069	COLLINS RICHARD & CATHY		
07-070	BOURGEOIS STEVEN & VALERIE		
07-071	MYRICK STEPHEN & CYNTHIA		
07-072	DEERING CLARENCE & KAREN		
07-073	PRATT DARWIN		
07-074	HUESTIS STEPHEN & SHEILA, TRUSTEES		
07-075	HUESTIS HAZEL ESTATE OF		
07-076	HAROLD & CHARLENE BARRETT FAMILY TRUST		
07-077	BISHOP WILLIAM L JR & JANE - LIFE ESTATE		
07-078	KORDA ANTHONY & KATHRYN		
07-079	SHIMEL RICHARD		
07-080	HARTLINE CINDY		
07-081	VICKERY JOHN C		
07-082	MASSED ALFRED & SUSAN		
07-083	NORTON CARL D FAMILY TRUST		
07-084	TOWN OF BRIDPORT		
07-085	LILLY MORGAN A		
07-086	DEGRAY FAMILY TRUST		
07-087	DEGRAY FAMILY TRUST		
07-088.1	LILLY JOHN M & MICHELLE L		
07-088.A	LILLY RICHARD -LIFE ESTATE		
07-089	NUNN OLIVER & KAREN LIFE ESTATE		
07-090	BORDELEAU MICHAEL V & LYNN M-3		
07-091	KENT ZACHERY B		
07-092	YETNICK LAWRENCE W		
07-093	FOLEY ANGELA M		
07-094	DEGRAY DEAN JOHN		
07-095	BORDELEAU MICHAEL V & LYNN M		
07-096	BRADY PAMELA		
07-097	BRIDPORT CONGREGATIONAL CHURCH		
07-098			
07-100	TOWN OF BRIDPORT		
07-101	SHELDRIK DONALD J		
07-102	TRI TOWN WATER DISTRICT NO. 1		
07-103	TOWN OF BRIDPORT		
07-104	THOMPSON NATHAN L		
07-104.A	ST BERNADETTE PARISH CHARITABLE TRUST		
07-105	TOWN OF BRIDPORT		
07-106	JANUARY LINDA M		
07-107	ROBINSON JOSHUA		
07-108	TRAUTWEILER GLEN A		
07-109	KORDA JOAN A		
07-110	MYRICK ELWYN & JOAN LIFE ESTATE		
07-111	RHEAUME MICHAEL & POLLY		
07-112	TOWN OF BRIDPORT		
07-113	ADDISON CENTRAL SCHOOL DISTRICT		
07-115	STANLEY MATTHEW A		
07-116	ROUSE KYLE		

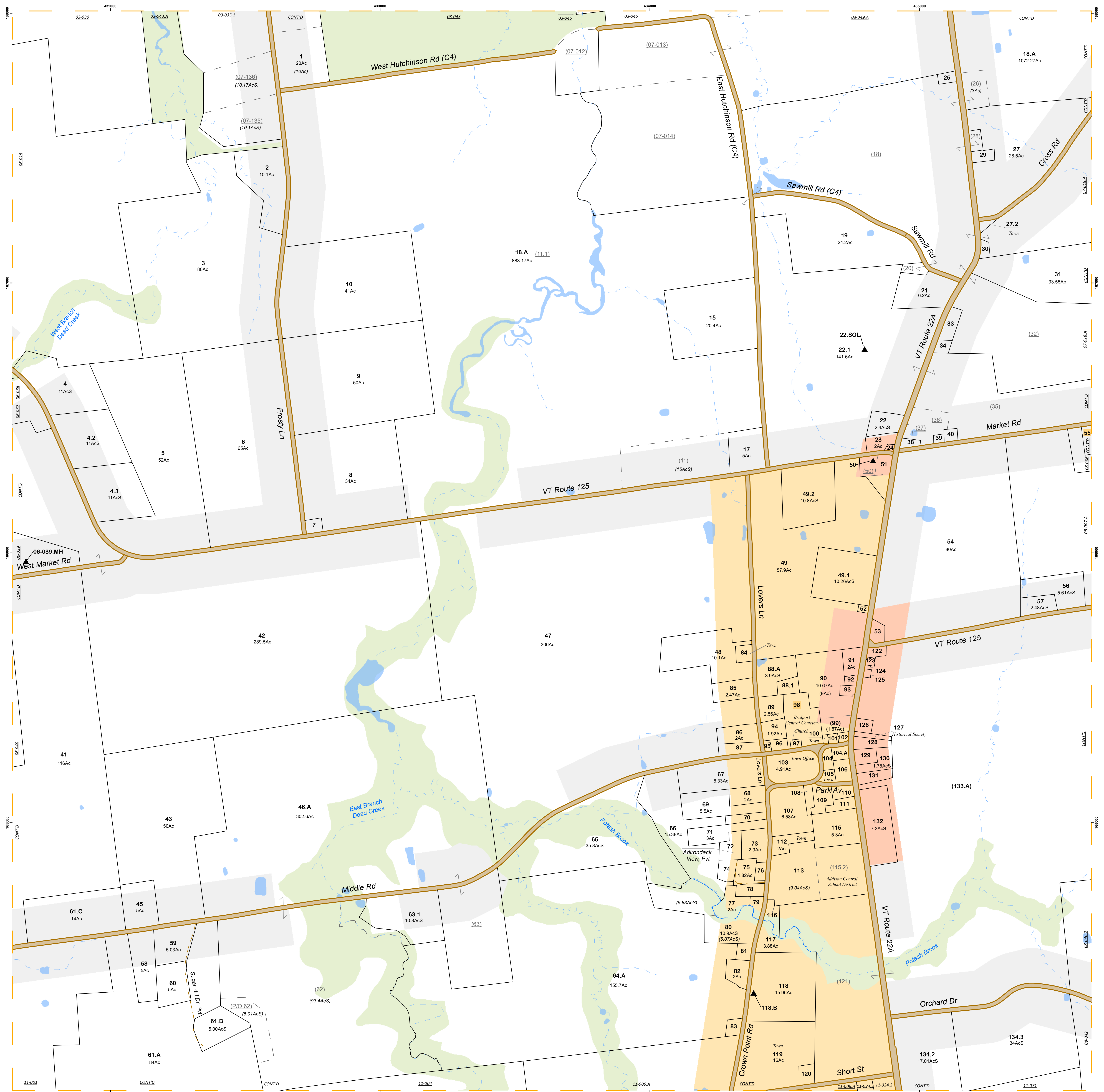
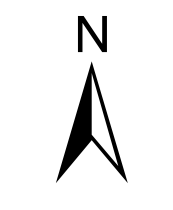

UPDATES BY  
**CHRISTINE CHAMBERLAIN  
MAPPING**

THESE MAPS ARE FOR ASSESSMENT PURPOSES ONLY.  
THEY ARE NOT TO BE USED FOR DESCRIPTION,  
CONVEYANCE, OR DETERMINATION OF LEGAL TITLE.  
ALL INFORMATION IS SUBJECT TO CHANGE.

<b>Legend</b>	<ul style="list-style-type: none"> <li>State boundary</li> <li>Town boundary</li> <li>Road boundary</li> <li>Parcel boundary</li> <li>Subparcel boundary</li> <li>Water boundary</li> <li>Right-of-Way</li> <li>Common Ownership</li> <li>Unlanded Property</li> <li>Surface water</li> <li>Match line</li> </ul>	<b>Zoning Adopted 2006</b> <ul style="list-style-type: none"> <li>Residential Agricultural District</li> <li>Residential District</li> <li>Conservation District</li> <li>Shoreland Planned Residential District</li> <li>Village District</li> <li>Neighborhood Commercial District</li> </ul>	<ul style="list-style-type: none"> <li>26 Parcel number (10.2AcS)</li> <li>(22) Subparcel number (1)</li> <li>(19) Historical parcel number</li> <li>10Ac Acres</li> <li>10AcS Acres surveyed</li> <li>10AcC Acres calculated</li> <li>(10.2AcS) Subparcel acres</li> <li>(1) Subdivision lot number</li> <li>06.086 Parcel number from adjoining sheet</li> <li>26 Parcel number not in grand list</li> <li>43000 State plane coordinates</li> </ul>
---------------	---	---	---

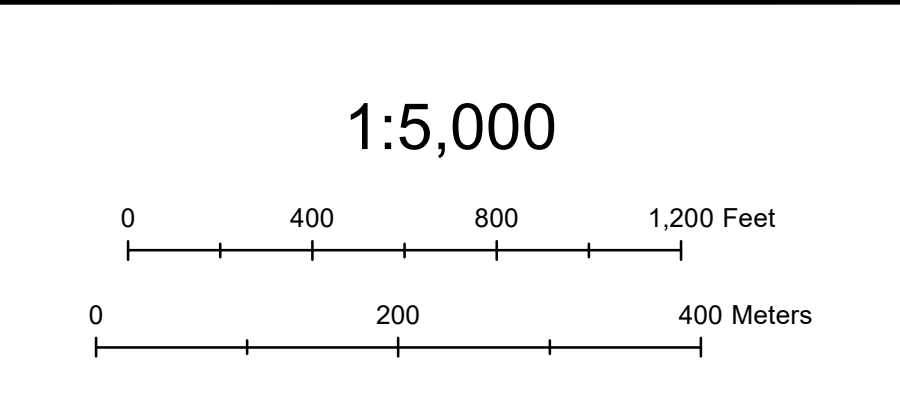

TOWN OF  
**BRIDPORT**  
VERMONT  
UPDATED THROUGH APRIL 1, 2022

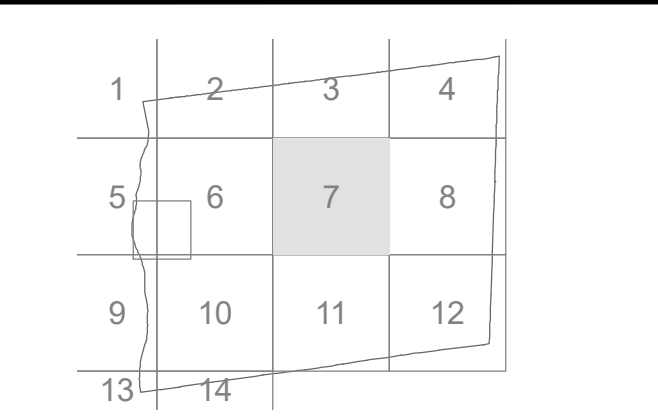

LOCAL MAP NO.  
**7**  
VERMONT SHEET 84164

## Index

MAPID	NAME
04-005.A	TRIPLE E FARMS LLC-7
04-049	BETOURNEY KEITH & KIMBERLY
04-058	PETERSON WILLIAM & SANDRA
04-068.A	PAYNE GARY
04-070	NATURE CONSERVANCY
04-071.1	ANDERSON TIMOTHY B & SUSAN M
04-071.3	LAFOUNTAIN TRAVIS JAMES
07-018.A	BLUE SPRUCE FARM INC-3
07-022.1	SHAW FARM INC-1
07-027	WALKER REVOCABLE LIVING TRUST
07-031	WALKER REVOCABLE LIVING TRUST
07-055	
08-001	PAYNE TRACI
08-003	MARKUT THEODORE A.
08-004.A	CLOHESSY PATRICK & LYNN
08-005.A	JORDAN DONALD & TINA
08-006	CRUM ELIZABETH C & DARBY L
08-007.A	LONG CLOUD FARM LLC
08-008.2	BRONSON FRANCIS LIFE ESTATE
08-010	PAYNE CHARLES
08-011	WEBER NANCY E
08-013	PAYNE RICHARD G
08-014	PAYNE GARY & CRISTINA
08-017	MERCIER ANDRE J & BARBARA H FAMILY TRUST
08-019	BRONSON BAILEY S
08-020	PAYNE FAMILY TRUST
08-020.1	DEERING CLARENCE & KAREN
08-020.2	BURKINS CHARLES L & GRACE J
08-020.3	BETOURNEY JASON
08-021	JACOBS TRAVIS 2004 REV TRUST
08-022	LABERGE GABRIEL R
08-023	BOISE JOEY & TAMARA
08-024.A	DEERING CLARENCE C
08-024.B	VT DEPT OF FISH & WILDLIFE
08-024.C	DEERING VIRGINIA MAE
08-026	SHIMEL MARK & LYNN JERGER & ODESSA WOOD
08-026.1	SHIMEL MARK & SHERRY
08-028	NOBLE THOMAS
08-029	SWEENEY JUDITH L TRUST
08-030	ELITHORPE BRIAN J & NICOLE L
08-031	WORLEY IAN A & MARY C - LIFE ESTATE
08-032	PAYNE BRUCE F
08-033	VALHALLA FARM LLC
08-034	BROUGHTON MARY ANN
08-036	GERO SHAWN & KIMBERLEE
08-037	BORDELEAU MICHAEL
08-038	BAIN CHARLES L & DIANA L TRUSTEES
08-039	BALLANTINE DANIEL P
08-039.A	ST GEORGE ROGER
08-039.B1	UPSON PENNY M
08-040.1	HOTTE JESSE & SHAWNA
08-040.2	TAYLOR LISA
08-040.3	BENOIT JULIA & MARCEL
08-040.31	KENSEY MICHELLE
08-040.4	HOTTE BROS LLP
08-040.5	COUSINEAU CLAUDE L
08-040.6	LAWRENCE JASON
08-040.62	GRUBER JOHN W
08-040.63	KENNEDY WILLIAM P
08-041	SHELDRIK WILLIAM SR & MICHELLE
08-042	BROUGHTON ADAM P
08-043	GOLD MARTIN
08-043.1	BROUGHTON'S FARM SUPPLY INC
08-044	SNYDER STEPHEN B
08-045	MURPHY ROGER A & MARIE C
08-045.1	BROUGHTON FRANCINE M
08-046	MYRICK KEVIN F
08-047.A	TIMOTHY INK LLC
08-048	LUKE HOTTE FAMILY TRUST
08-049	MILLER THOMAS
08-051	MILLER THOMAS
08-052	SHAW FARM INC.-2
08-054	WHITTEMORE TRAVUS
08-055	MACDONALD GREG R
08-056	ST GEORGE HILL TRUST
08-056.1	MALZAC CORY
08-057.2	PAYNE FAMILY TRUST
08-057.3	QUESNEL MICHAEL & LISA
08-058	VT DEPT OF FISH & WILDLIFE
08-059	VT DEPT OF FISH & WILDLIFE
08-063	STOCKMAN AMY T
08-065	DEERING CHESLEY & TINA LIFE ESTATE
08-066	VT DEPT OF FISH & WILDLIFE
08-067	
12-012	QUESNEL RANDY & JEAN
12-012.A	VT FISH & WILDLIFE DEPARTMENT
Unlanded	
08-039.B	HUESTIS STACY

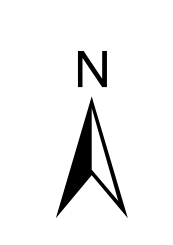

UPDATES BY  
**CHRISTINE CHAMBERLAIN**  
MAPPING

THESE MAPS ARE FOR ASSESSMENT PURPOSES ONLY. THEY ARE NOT TO BE USED FOR DESCRIPTION, CONVEYANCE, OR DETERMINATION OF LEGAL TITLE. ALL INFORMATION IS SUBJECT TO CHANGE.

<b>Legend</b>	<ul style="list-style-type: none"> <li>State boundary</li> <li>Town boundary</li> <li>Road boundary</li> <li>Parcel boundary</li> <li>Subparcel boundary</li> <li>Water boundary</li> <li>Right-of-Way</li> <li>Common Ownership</li> <li>Undeveloped Property</li> <li>Surface water</li> <li>Match line</li> </ul>	<p><b>Zoning Adopted 2006</b></p> <ul style="list-style-type: none"> <li>Residential Agricultural District</li> <li>Residential District</li> <li>Conservation District</li> <li>Shoreland Planned Residential District</li> <li>Village District</li> <li>Neighborhood Commercial District</li> </ul>	<p>26 Parcel number (10.2AcS) Subparcel acres</p> <p>(22) Subparcel number (1) Subdivision lot number</p> <p>(19) Historical parcel number 06-086 Parcel number from adjoining sheet</p> <p>10Ac Acres</p> <p>10AcS Acres surveyed</p> <p>10AcC Acres calculated</p> <p>26 Parcel number not in grand list</p> <p>43000 State plane coordinates</p>
---------------	--	--	---

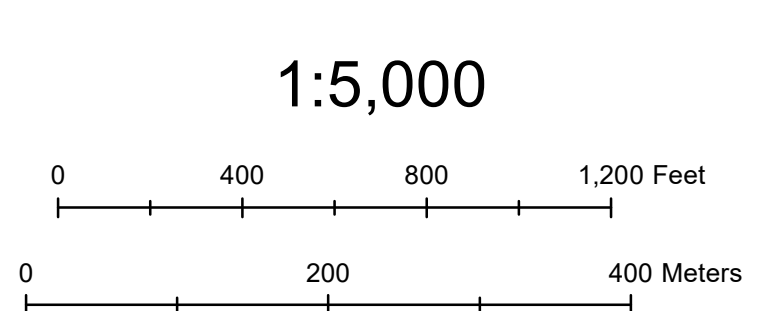

TOWN OF  
**BRIDPORT**  
VERMONT

UPDATED THROUGH APRIL 1, 2022

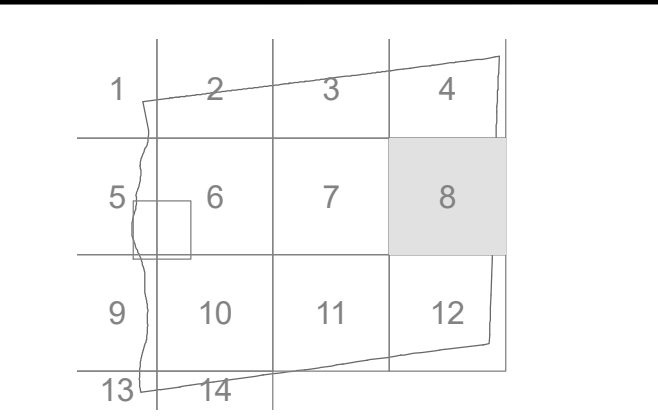

LOCAL MAP NO.  
**8**

VERMONT SHEET 88164

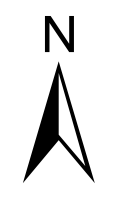
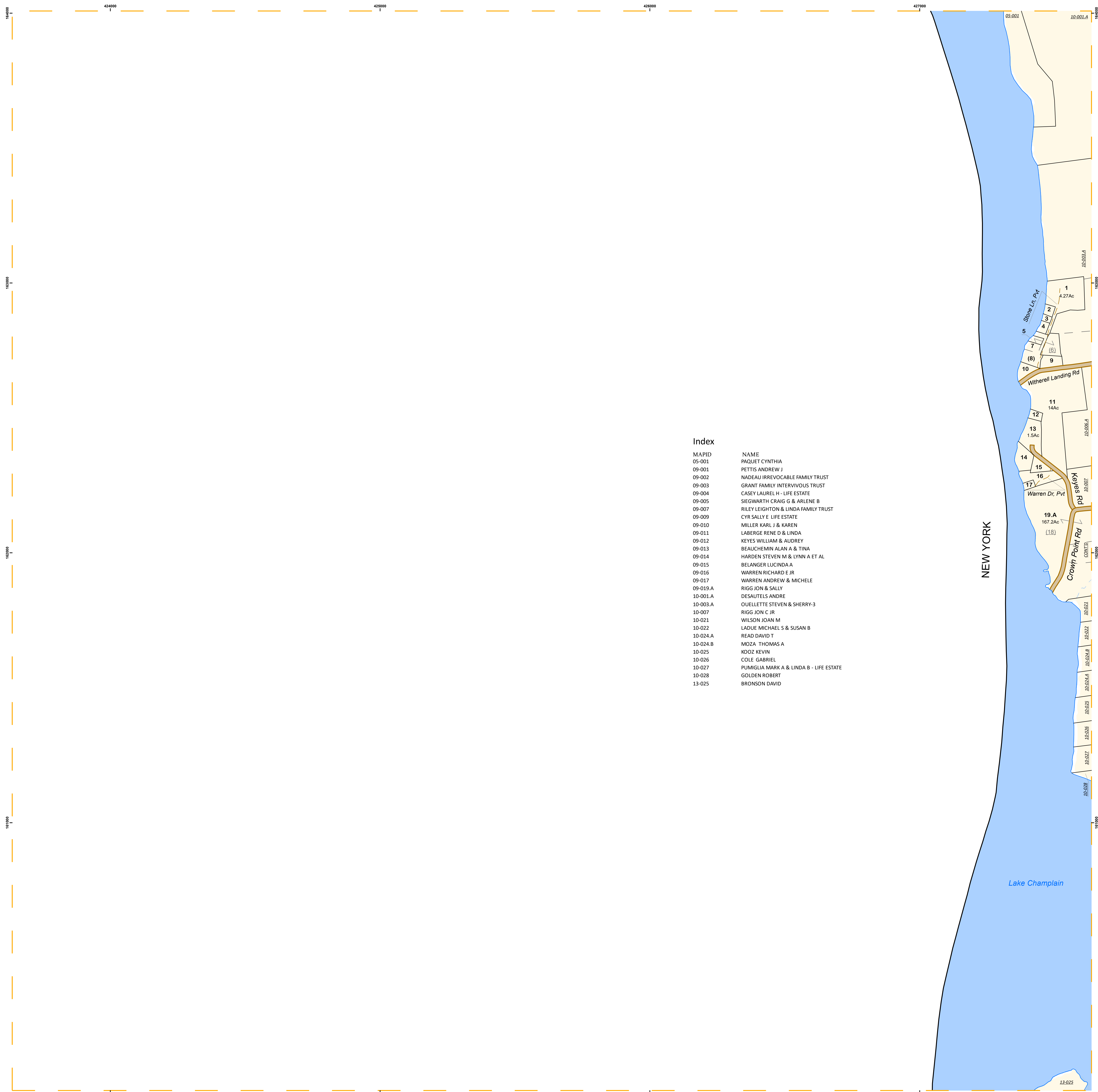

**Index**

M.A.P.I.D	NAME
05-001	PAQUET CYNTHIA
09-001	PETTIS ANDREW J
09-002	NADÉAU IRREVOCABLE FAMILY TRUST
09-003	GRANT FAMILY INTERVIVOUS TRUST
09-004	CASEY LAUREL H - LIFE ESTATE
09-005	SIEGWARTH CRAIG G & ARLENE B
09-007	RILEY LEIGHTON & LINDA FAMILY TRUST
09-009	CYR SALLY E LIFE ESTATE
09-010	MILLER KARL J & KAREN
09-011	LABERGE RENE D & LINDA
09-012	KEYES WILLIAM & AUDREY
09-013	BEAUCHEMIN ALAN A & TINA
09-014	HARDEN STEVEN M & LYNN A ET AL
09-015	BELANGER LUCINDA A
09-016	WARREN RICHARD E JR
09-017	WARREN ANDREW & MICHELE
09-019.A	RIGG JON & SALLY
10-001.A	DESAUTELS ANDRE
10-003.A	OUELLETTE STEVEN & SHERRY-3
10-007	RIGG JON C JR
10-021	WILSON JOAN M
10-022	LADUE MICHAEL S & SUSAN B
10-024.A	READ DAVID T
10-024.B	MOZA THOMAS A
10-025	KOZ KEVIN
10-026	COLE GABRIEL
10-027	PUMIGLIA MARK A & LINDA B - LIFE ESTATE
10-028	GOLDEN ROBERT
13-025	BRONSON DAVID

UPDATES BY  
**CHRISTINE CHAMBERLAIN  
MAPPING**

THESE MAPS ARE FOR ASSESSMENT PURPOSES ONLY. THEY ARE NOT TO BE USED FOR DESCRIPTION, CONVEYANCE, OR DETERMINATION OF LEGAL TITLE. ALL INFORMATION IS SUBJECT TO CHANGE.

**Legend**

State boundary	Right-of-Way	Zoning Adopted 2006	Shoreland Planned Residential District	<b>26</b> Parcel number (10.2AcS) Subparcel acres
Town boundary	Common Ownership	Residential Agricultural District	Village District	<b>(22)</b> Subparcel number (1) Subdivision lot number
Road boundary	Untended Property	Residential District	Neighborhood Commercial District	<b>(19)</b> Historical parcel number 06-086 Parcel number from adjoining sheet
Parcel boundary	Surface water	Conservation District		<b>10Ac</b> Acres surveyed <b>26</b> Parcel number not in grand list
Subparcel boundary	Match line			<b>10AcS</b> Acres surveyed 43000 State plane coordinates
Water boundary				<b>10AcC</b> Acres calculated

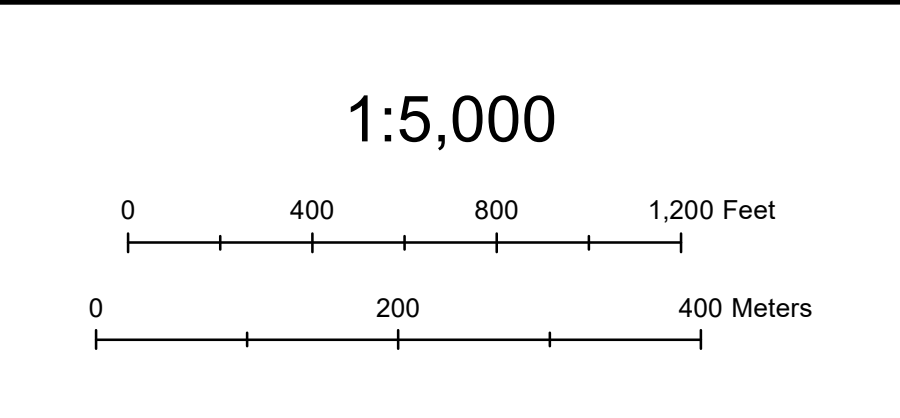

TOWN OF  
**BRIDPORT**  
VERMONT

UPDATED THROUGH APRIL 1, 2022

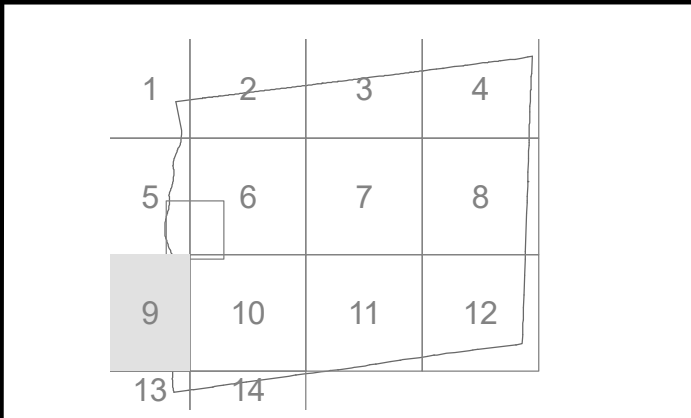

LOCAL MAP NO.  
**9**

VERMONT SHEET 76160

## Index

MAPID	NAME
06-026.A	BLISSFUL DAIRY LLC
06-031.A	HUESTIS ARTHUR & JOAN-2
09-019.A	RIGG JON & SALLY
10-001.A	DESAUTELS ANDRE
10-003.A	OUELLETTE STEVEN & SHERRY-3
10-004	OUELLETTE HARMEL - LIFE ESTATE
10-007	RIGG JON C JR
10-008	
10-014	FLEMING RANDALL W & MICHELLE K
10-015.2	WELCH CHARLES JR & KATIE E
10-015.4A	HUESTIS ARTHUR & JOAN-3
10-015.5	HUESTIS CLAIRE
10-016.A	SUNDERLAND HAROLD & LARRY
10-017	FITZPATRICK CARMA
10-018	YUSTIN DAVID & SUSAN
10-021	WILSON JOAN M
10-022	LADUE MICHAEL S & SUSAN B
10-024.A	READ DAVID T
10-024.B	MOZA THOMAS A
10-025	KOOZ KEVIN
10-026	COLE GABRIEL
10-027	PUMIGLIA MARK A & LINDA B - LIFE ESTATE
10-028	GOLDEN ROBERT
10-029	4738 LAKE STREET LLC
10-030	TESTONE MICHAEL G
10-031	EPLER JOSEPH F JR
10-032	PLANTE RAYNE
10-033	GLEASON JOSEPH-1
10-034	POORE JASON
10-038	HADLEY WILLIAM B
10-038.3	PATTERSON TAYLOR J
10-039.A	SMITS WILLIAM & JOANNE
10-040	OUELLETTE STEVEN & SHERRY-4
10-041.A	LAWTON HENRY IV
10-042	GIARD HELEN, ESTATE OF
10-043	BUCK RUSSELL
10-044	HUESTIS BENJAMIN J
10-045	PLOOF ARTHUR E JR & DEBORAH H
10-046	HUESTIS PROPERTIES LLC
10-047	SMITS WILLIAM
10-048	DECAMBRA DEBORAH SHARPLES
10-049	BLODGETT WILLIAM T
10-050.2	HOB DAY KEITH & SUZANNE
10-050.A	BARNES DANIEL E
10-052	HUESTIS JOAN R
10-053	GABORIAULT PAUL L
10-054	WELLS PAUL & CHRISTINE
10-056	FORBES BRIAN & LINDA - LIFE ESTATE
10-059	OUELLETTE STEVEN & SHERRY-2
10-060	SAENGER RENE
11-001	TIMUR FARMS INC.
11-072	SUNDERLAND L HAROLD
Unlanded	
10-047.B	SMITS WILLIAM & JOANNE
10-050.B	BARNES BLACK



UPDATES BY  
**CHRISTINE CHAMBERLAIN  
MAPPING**

THESE MAPS ARE FOR ASSESSMENT PURPOSES ONLY.  
THEY ARE NOT TO BE USED FOR DESCRIPTION,  
CONVEYANCE, OR DETERMINATION OF LEGAL TITLE.  
ALL INFORMATION IS SUBJECT TO CHANGE.

<b>Legend</b>	<ul style="list-style-type: none"> <li>State boundary</li> <li>Town boundary</li> <li>Road boundary</li> <li>Parcel boundary</li> <li>Subparcel boundary</li> <li>Water boundary</li> <li>Right-of-Way</li> <li>Common Ownership</li> <li>Undeveloped Property</li> <li>Surface water</li> <li>Match line</li> </ul>	<b>Zoning Adopted 2006</b> <ul style="list-style-type: none"> <li>Residential Agricultural District</li> <li>Residential District</li> <li>Conservation District</li> <li>Shoreland Planned Residential District</li> <li>Village District</li> <li>Neighborhood Commercial District</li> </ul>	<ul style="list-style-type: none"> <li>26 Parcel number (10.2AcS) Subparcel acres</li> <li>(22) Subparcel number (1) Subdivision lot number</li> <li>(19) Historical parcel number 06-086 Parcel number from adjoining sheet</li> <li>10AcS Acres surveyed</li> <li>10AcC Acres calculated</li> <li>26 Parcel number not in grand list</li> <li>43000 State plane coordinates</li> </ul>
---------------	--	---	--

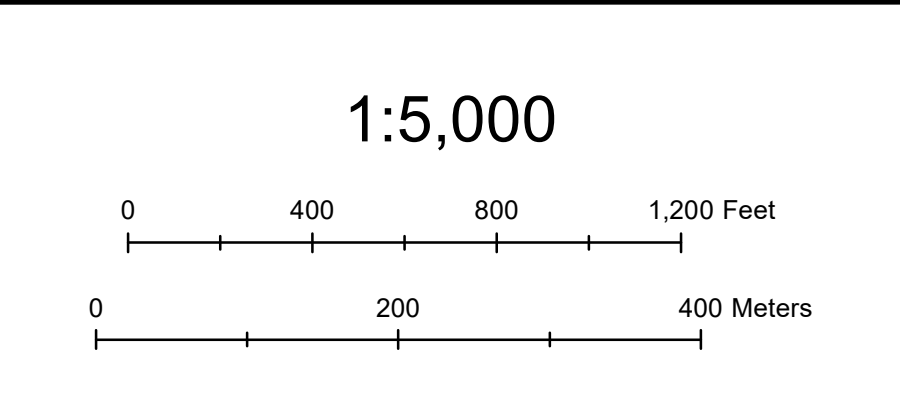

TOWN OF  
**BRIDPORT**  
VERMONT

UPDATED THROUGH APRIL 1, 2022

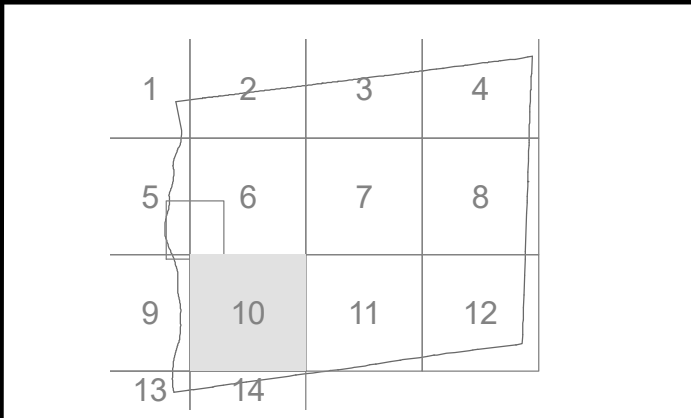

LOCAL MAP NO.  
**10**

VERMONT SHEET 80160



## Index

MAPID	NAME
07-046.A	BLISSFUL DAIRY LLC
07-061.A	MYRICK ROBERT L. SR FAMILY TRUST
07-119	TOWN OF BRIDPORT
07-134.2	HOTTE LUKE FAMILY TRUST
07-134.3	HOTTE TIMOTHY
08-042	BROUGHTON ADAM P
10-016.A	SUNDERLAND HAROLD & LARRY
10-017	FITZPATRICK CARMA
10-060	SAENGER RENE
11-001	TIMUR FARMS INC.
11-002	SCOTT RICHARD S & ROBIN J
11-002.1	SCOTT RICHARD S
11-003	COFFEY ROBERT
11-004	GILE RONALD & CAROL
11-005	WINKLER LISA J
11-006.A	SUHR WILLIAM F
11-008	TOLEDANO JENNIFER C & MIGUELA
11-009.1	HODSDEN KEITH D & HEATHER S
11-009.2	LOGAN JUSTINE
11-009.3	DAMONE PETER & DOROTHY
11-009.4	THOMAS SHAWN M
11-009.5	THOMAS DANIEL J
11-010	STONE DALE H & STONE ANN M FAMILY TRUST
11-011	CLARK JANET
11-012.1	STONE TRACY M
11-013	ONEILL ADAM J
11-014.2	GILE ELOE R
11-015	COURSEY PATRICIA
11-016	BARROWS CECELIA W LIFE ESTATE
11-018.A	GIARD HELEN, ESTATE OF
11-019	HUESTIS SHEILA A
11-020	WHITE FAMILY REVOCABLE TRUST
11-021	GIARD SHIRLEY G
11-022	MYRICK KATHRYN GIARD FAMILY TRUST
11-024.2	RYKS BRIAN J
11-024.3	GIARD DORIS M
11-025	BENOIT DENNIS J LIFE ESTATE
11-025.1	GIARD MARILYN L
11-025.B	BENOIT WOODS FAMILY TRUST
11-026	BENOIT BRIAN
11-027	NADEAU MATTHEW J A
11-029	ROSE NICOLE
11-031.A	STONE NORMA L FAMILY TRUST
11-034	PLOUFFE PAUL N A & REBECCA
11-036	CHOINIERE PAUL L
11-037.A	BOLDUC EUGENE A & DIANE L
11-038.A	TRIPLE E FARMS LLC-9
11-039	OUELLETTE STEVEN & SHERRY-1
11-041	BASQUE DAVID J
11-042.A	SUHR WILLIAM F
11-043	TOWN OF BRIDPORT
11-046.A	PLOUFFE JEAN TRUSTEES-1
11-050.1	WAGNER JEFFREY P
11-050.A	WAGNER PHILIP H
11-051.A	CHOINIERE PAUL L
11-052	ANDERSON JAMES & MEREDITH
11-053.A	WRIGHT H KENT III
11-054	WHITTEMORE JASON
11-055	PLOUFFE PAUL & REBECCA
11-057	HIGHLEY SUSAN
11-058	CASTLE CURTIS S
11-060	SURPRENANT MARGARET J & RICHARD H
11-061	MACLACHLAN DOUGLAS N
11-062	MYRICK CYNTHIA
11-063	SUNDERLAND RONNIE
11-065.A	ETHIER JEFFEY S
11-066	WAGNER PAUL & BARBARA-2
11-071	DUDDLES CRAIG W
11-072	SUNDERLAND L HAROLD
11-073	GIARD HAROLD & SHIRLEY-2
12-017	GABORIAULT CLEMENT & JOYCE-2
12-026	IROQUOIS ACRES NWA LLC
Unlanded	
11-062.B	MYRICK STEPHEN A JR
11-073.S	SAVAGE SOLAR LLC



UPDATES BY  
**CHRISTINE CHAMBERLAIN**  
MAPPING

THESE MAPS ARE FOR ASSESSMENT PURPOSES ONLY. THEY ARE NOT TO BE USED FOR DESCRIPTION, CONVEYANCE, OR DETERMINATION OF LEGAL TITLE. ALL INFORMATION IS SUBJECT TO CHANGE.

Legend		Zoning Adopted 2006	
	State boundary		Right-of-Way
	Town boundary		Residential Agricultural District
	Road boundary		Village District
	Parcel boundary		Neighborhood Commercial District
	Subparcel boundary		Conservation District
	Water boundary		Untended Property
	Common Ownership		Surface water
	Match line		Match line

26	Parcel number (10.2AcS)	Subparcel acres
(22)	Subparcel number	(1) Subdivision lot number
(19)	Historical parcel number	06-086 Parcel number from adjoining sheet
10Ac	Acres	26 Parcel number not in grand list
10AcS	Acres surveyed	43000 State plane coordinates
10AcC	Acres calculated	

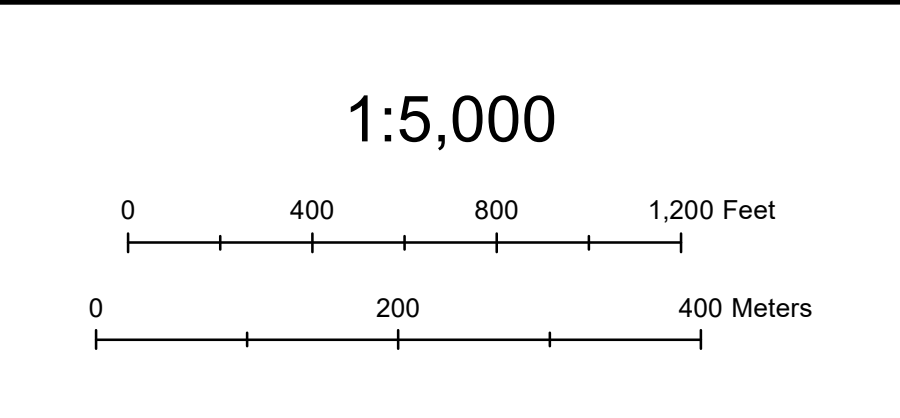

TOWN OF  
**BRIDPORT**  
VERMONT

UPDATED THROUGH APRIL 1, 2022

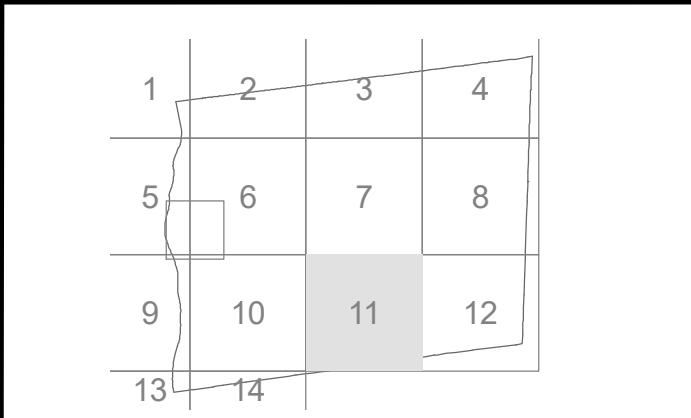

LOCAL MAP NO.  
**11**

VERMONT SHEET 84160

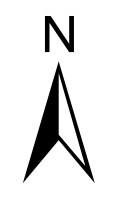

CORNWALL

SHOREHAM

MAPID	NAME	MAPID	NAME
00-001	VT DEPT OF FISH & WILDLIFE	12-008	LAWTON HENRY
00-002	VT DEPT OF FISH & WILDLIFE-5	12-010	VT DEPT OF FISH & WILDLIFE
08-024.B	VT DEPT OF FISH & WILDLIFE	12-012	QUESNEL RANDY & JEAN
08-042	BROUGHTON ADAM P	12-012.A	VT FISH & WILDLIFE DEPARTMENT
08-044	SNYDER STEPHEN B	12-013	CESARIO MARC
08-045	MURPHY ROGER A & MARIE C	12-013.2	VT DEPT OF FISH & WILDLIFE
08-046	MURPHY ROGER A & MARIE C	12-014	WRIGHT H KENT III
08-058	VT DEPT OF FISH & WILDLIFE	12-015	MCLEAN RYAN D
11-027	NADEAU MATTHEW J A	12-016	CARTER KEVIN & LINDA
11-029	ROSE NICOLE	12-017	GABORIAULT CLEMENT & JOYCE-2
11-046.A	PLOUFFE JEAN TRUSTEES-1	12-018	MCLEAN RYAN D
11-053.A	WRIGHT H KENT III	12-019	ETHIER MATTHEW
11-065.A	ETHIER JEFFEY S	12-020	GLEASON JOSEPH H-2
12-001	GIARD HELEN, ESTATE OF	12-020.A	WHITTEMORE TRAVUS J
12-002	DENU PHILLIP E JR - LIFE ESTATE	12-021	ROBINSON SHERRILL F & JEROME B - TRUSTEE
12-003	VANACORE THOMAS	12-022	ETHIER JEFFREY
12-004	DEERING HAROLD J	12-025	ETHIER EUGENE E & JANICE A
12-005	WHITTEMORE GEORGE & YVETTE	12-026	IROQUOIS ACRES NWA LLC
12-007	WRIGHT H KENT III	12-029	VERDANT PROPERTIES LLC
		12-030	CLARK FAMILY TRUST
		12-031.A	VAN HAZINGA VIRGINIA R LIVING TRUST
		12-032	KPS VENTURES LLC
			Unlanded
			12-019.B
			ETHIER EUGENE E & JANICE W

UPDATES BY  
**CHRISTINE CHAMBERLAIN**  
MAPPING

THESE MAPS ARE FOR ASSESSMENT PURPOSES ONLY. THEY ARE NOT TO BE USED FOR DESCRIPTION, CONVEYANCE, OR DETERMINATION OF LEGAL TITLE. ALL INFORMATION IS SUBJECT TO CHANGE.

**Legend**

- State boundary
- Town boundary
- Road boundary
- Parcel boundary
- Subparcel boundary
- Water boundary
- Right-of-Way
- Common Ownership
- Unlanded Property
- Surface water
- Match line

**Zoning Adopted 2006**

- Residential Agricultural District
- Residential District
- Conservation District
- Shoreland Planned Residential District
- Village District
- Neighborhood Commercial District

**26** Parcel number (10.2AcS) Subparcel acres  
**(22)** Subparcel number (1) Subdivision lot number  
**(19)** Historical parcel number **06-086** Parcel number from adjoining sheet  
**10Ac** Acres  
**10AcS** Acres surveyed  
**10AcC** Acres calculated

**26** Parcel number not in grand list  
**43000** State plane coordinates

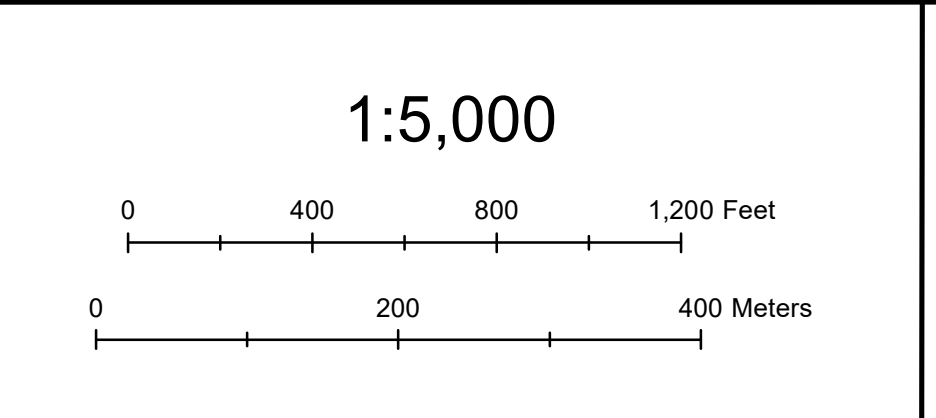

TOWN OF  
**BRIDPORT**  
VERMONT

UPDATED THROUGH APRIL 1, 2022

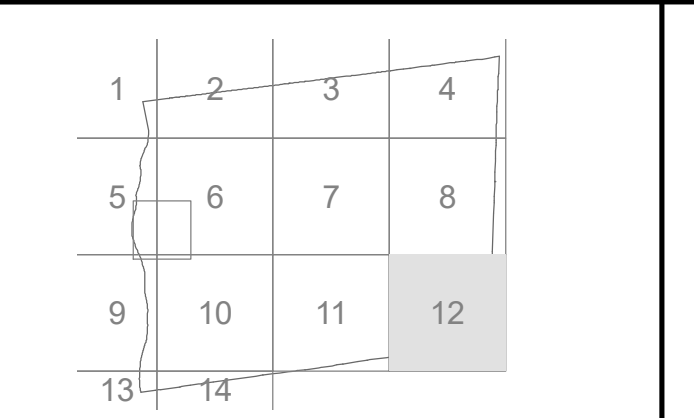

LOCAL MAP NO.  
**12**

VERMONT SHEET 88160

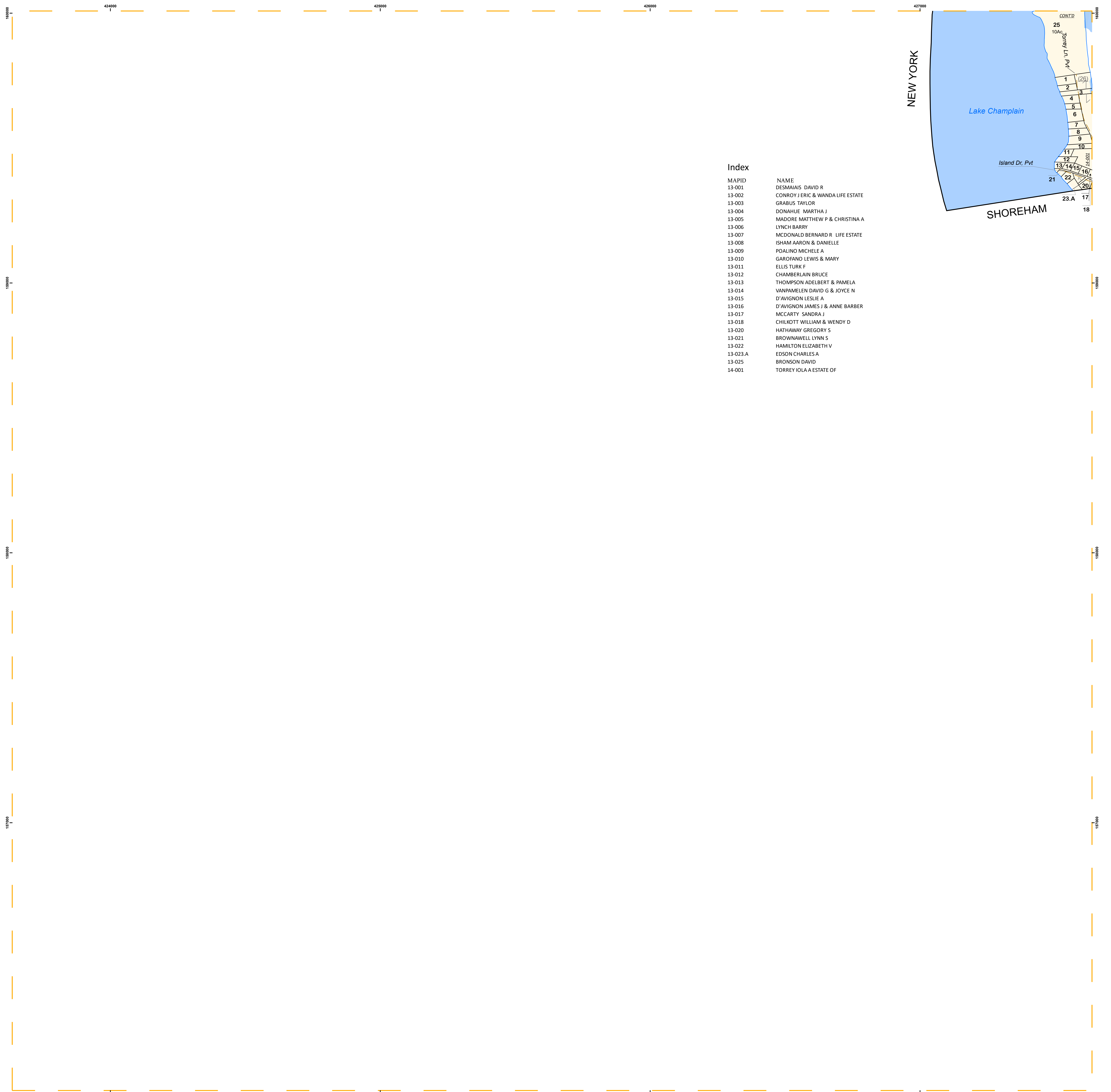

**Index**

MAPID	NAME
13-001	DESMARIS DAVID R
13-002	CONROY J ERIC & WANDA LIFE ESTATE
13-003	GRABUS TAYLOR
13-004	DONAHUE MARTHA J
13-005	MADORE MATTHEW P & CHRISTINA A
13-006	LYNCH BARRY
13-007	MCDONALD BERNARD R LIFE ESTATE
13-008	ISHAM AARON & DANIELLE
13-009	POALINO MICHELE A
13-010	GAROFANO LEWIS & MARY
13-011	ELLIS TURK F
13-012	CHAMBERLAIN BRUCE
13-013	THOMPSON ADELBERT & PAMELA
13-014	VANPAMELEN DAVID G & JOYCE N
13-015	D'AVIGNON LESLIE A
13-016	D'AVIGNON JAMES J & ANNE BARBER
13-017	MCCARTY SANDRA J
13-018	CHILKOTT WILLIAM & WENDY D
13-020	HATHAWAY GREGORY S
13-021	BROWNAWELL LYNN S
13-022	HAMILTON ELIZABETH V
13-023.A	EDSON CHARLES A
13-025	BRONSON DAVID
14-001	TORREY IOILA A ESTATE OF

UPDATES BY  
**CHRISTINE CHAMBERLAIN  
MAPPING**

THESE MAPS ARE FOR ASSESSMENT PURPOSES ONLY. THEY ARE NOT TO BE USED FOR DESCRIPTION, CONVEYANCE, OR DETERMINATION OF LEGAL TITLE. ALL INFORMATION IS SUBJECT TO CHANGE.

**Legend**

	State boundary		Right-of-Way		Shoreland Planned Residential District
	Town boundary		Common Ownership		Residential Agricultural District
	Road boundary		Untended Property		Residential District
	Parcel boundary		Surface water		Conservation District
	Subparcel boundary		Match line		Neighborhood Commercial District
	Water boundary				

26	Parcel number	(10.2AcS)	Subparcel acres
(22)	Subparcel number	(1)	Subdivision lot number
(19)	Historical parcel number	06-086	Parcel number from adjoining sheet
10Ac	Acres surveyed	26	Parcel number not in grand list
10AcS	Acres surveyed	43000	State plane coordinates
10AcC	Acres calculated		

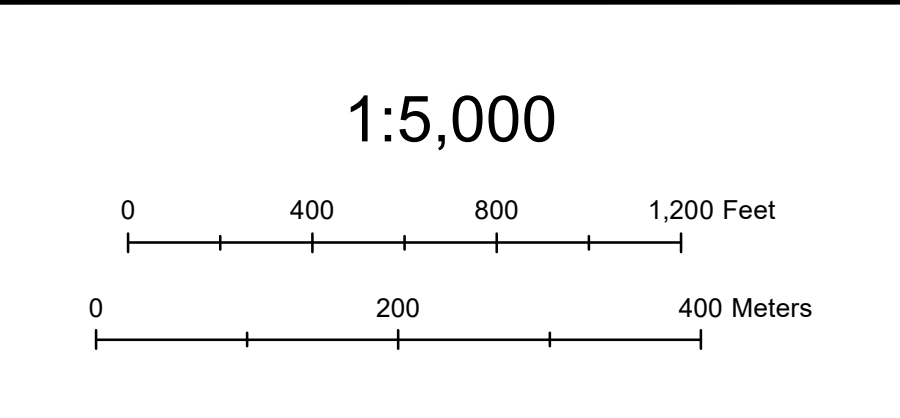

TOWN OF  
**BRIDPORT**  
VERMONT

UPDATED THROUGH APRIL 1, 2022

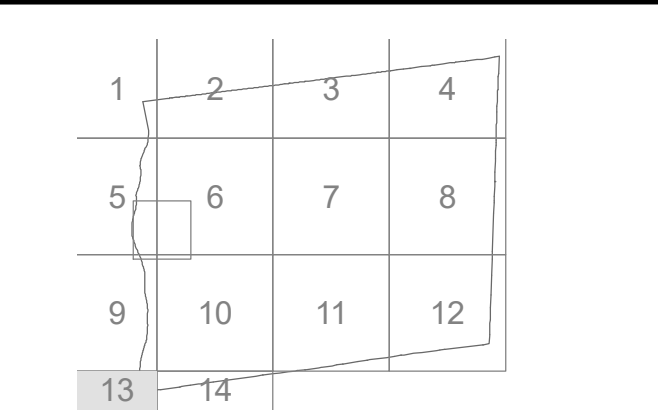

LOCAL MAP NO.  
**13**

VERMONT SHEET 76156

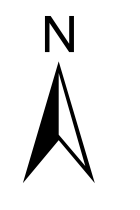
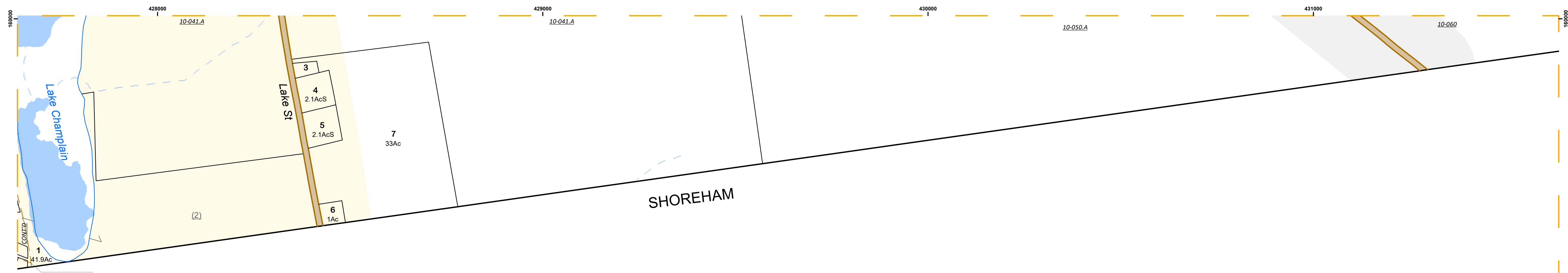

SHOREHAM

**Index**

MAPID	NAME
10-041.A	LAWTON HENRY IV
10-050.A	BARNES DANIEL E
10-060	SAENGER RENE
13-003	GRABUS TAYLOR
13-009	POALINO MICHELE A
13-010	GAROFANO LEWIS & MARY
13-017	MCCARTY SANDRA J
13-018	CHILKOTT WILLIAM & WENDY D
13-020	HATHAWAY GREGORY S
14-001	TORREY IOLA A ESTATE OF
14-003	OUELLETTE STEVEN & SHERRY-5
14-004	IBSEN DAVID
14-005	BENOIT DAVID
14-006	GABRIEL JAMES
14-007	BARNES DANIEL E

UPDATES BY  
**CHRISTINE CHAMBERLAIN**  
MAPPING

THESE MAPS ARE FOR ASSESSMENT PURPOSES ONLY. THEY ARE NOT TO BE USED FOR DESCRIPTION, CONVEYANCE, OR DETERMINATION OF LEGAL TITLE. ALL INFORMATION IS SUBJECT TO CHANGE.

**Legend**

State boundary	Right-of-Way	<b>Zoning Adopted 2006</b>	Shoreland Planned Residential District	<b>26</b> Parcel number (10.2AcS) Subparcel acres	Parcel number	(10.2AcS) Subparcel acres
Town boundary	Common Ownership	Residential Agricultural District	Village District	<b>(22)</b> Subparcel number (1) Subdivision lot number	Historical parcel number	(1) Subdivision lot number
Road boundary	Undeveloped Property	Residential District	Neighborhood Commercial District	<b>(19)</b> Acres surveyed	Parcel number from adjoining sheet	Parcel number from adjoining sheet
Parcel boundary	Surface water	Conservation District		<b>10Ac</b> Acres surveyed	Parcel number not in grand list	Parcel number not in grand list
Subparcel boundary	Match line			<b>10AcC</b> Acres calculated	State plane coordinates	State plane coordinates
Water boundary						

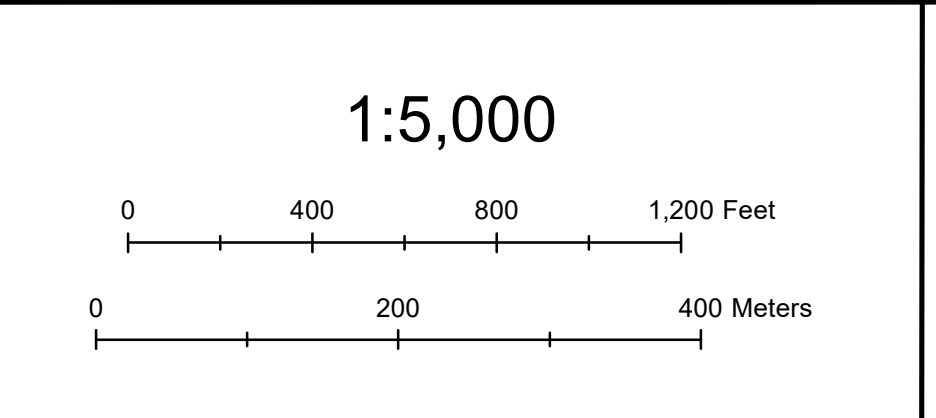

TOWN OF  
**BRIDPORT**  
VERMONT  
UPDATED THROUGH APRIL 1, 2022

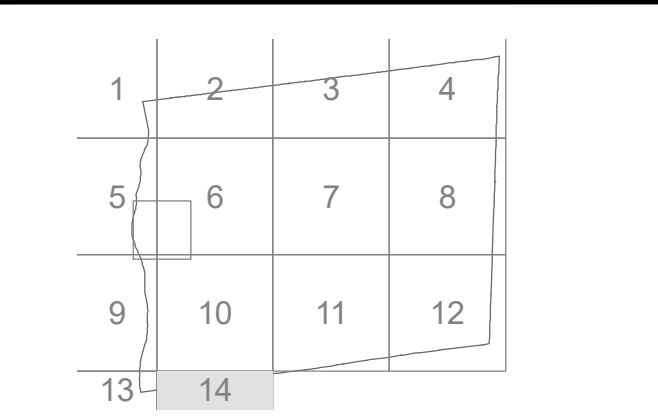

LOCAL MAP NO.  
**14**  
VERMONT SHEET 80156

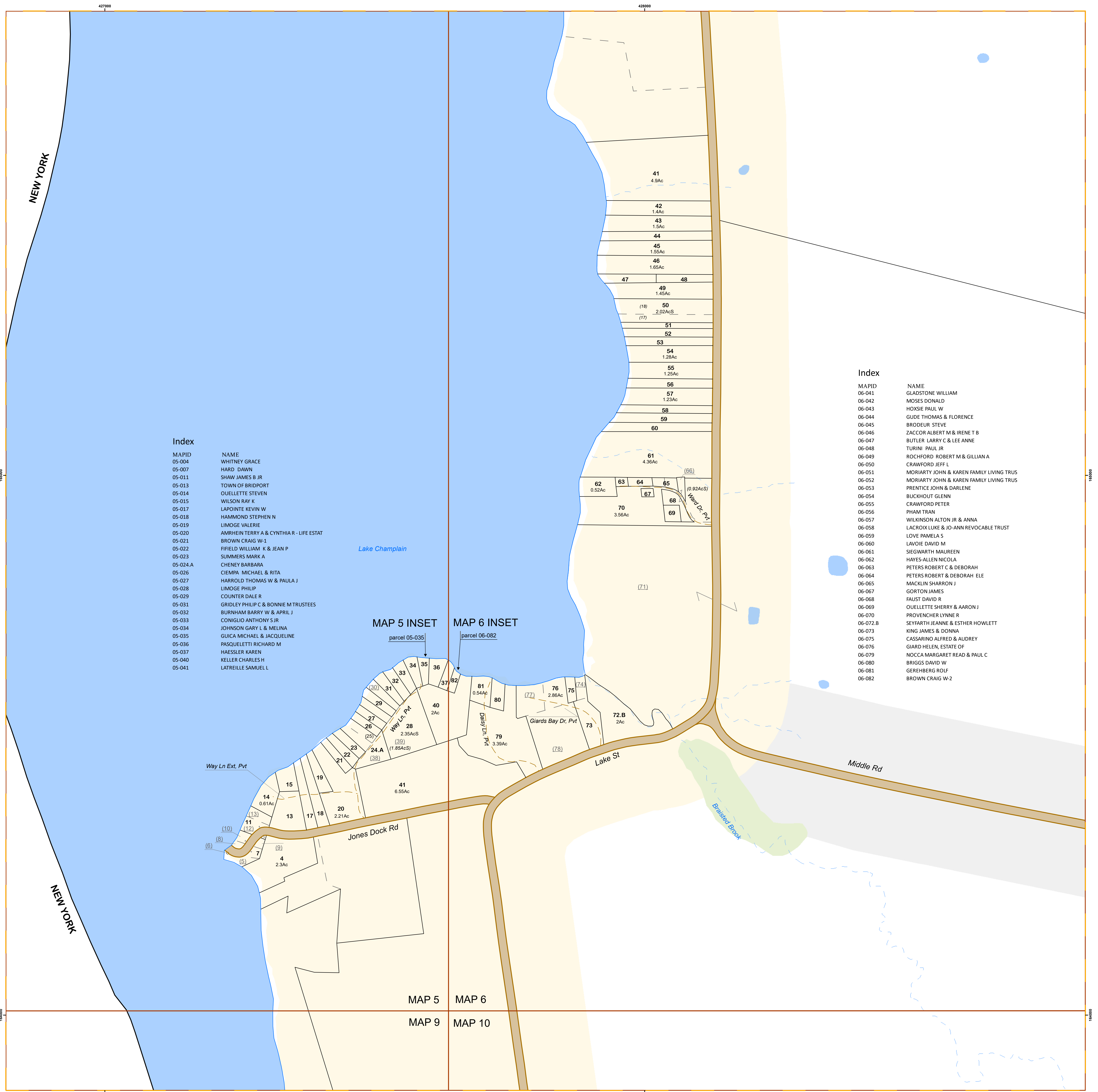
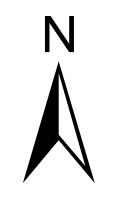

**Index**

MAPID	NAME
05-004	WHITNEY GRACE
05-007	HARD DAWN
05-011	SHAW JAMES B JR
05-013	TOWN OF BRIDPORT
05-014	OUELLETTE STEVEN
05-015	WILSON RAY K
05-017	LAPOINTE KEVIN W
05-018	HAMMOND STEPHEN N
05-019	LIMOGUE VALERIE
05-020	AMRHEIN TERRY A & CYNTHIA R - LIFE ESTAT
05-021	BROWN CRAIG W-1
05-022	FIFIELD WILLIAM K & JEAN P
05-023	SUMMERS MARK A
05-024.A	CHENEY BARBARA
05-026	CIEMPA MICHAEL & RITA
05-027	HARROLD THOMAS W & PAULA J
05-028	LIMOGUE PHILIP
05-029	COUNTER DALE R
05-031	GRIDLEY PHILIP C & BONNIE M TRUSTEES
05-032	BURNHAM BARRY W & APRIL J
05-033	CONIGLIO ANTHONY S JR
05-034	JOHNSON GARY L & MELINA
05-035	GUICA MICHAEL & JACQUELINE
05-036	PASQUELETTI RICHARD M
05-037	HAESSLER KAREN
05-040	KELLER CHARLES H
05-041	LATREILLE SAMUEL L

**Index**

MAPID	NAME
06-041	GLADSTONE WILLIAM
06-042	MOSES DONALD
06-043	HOXSIE PAUL W
06-044	GUDE THOMAS & FLORENCE
06-045	BRODEUR STEVE
06-046	ZACCOR ALBERT M & IRENE T B
06-047	BUTLER LARRY C & LEE ANNE
06-048	TURINI PAUL JR
06-049	ROCHFORD ROBERT M & GILLIAN A
06-050	CRAWFORD JEFF L
06-051	MORIARTY JOHN & KAREN FAMILY LIVING TRUS
06-052	MORIARTY JOHN & KAREN FAMILY LIVING TRUS
06-053	PRENTICE JOHN & DARLENE
06-054	BUCKHOUT GLENN
06-055	CRAWFORD PETER
06-056	PHAM TRAN
06-057	WILKINSON ALTON JR & ANNA
06-058	LACROIX LUKE & JO-ANN REVOCABLE TRUST
06-059	LOVE PAMELA S
06-060	LAVOIE DAVID M
06-061	SIEGWARTH MAUREEN
06-062	HAYES-ALLEN NICOLA
06-063	PETERS ROBERT C & DEBORAH
06-064	PETERS ROBERT & DEBORAH ELE
06-065	MACKLIN SHARRON J
06-067	GORTON JAMES
06-068	FAUST DAVID R
06-069	OUELLETTE SHERRY & AARON J
06-070	PROVENCHE LYNNE R
06-072.B	SEVFARTH JEANNE & ESTHER HOWLETT
06-073	KING JAMES & DONNA
06-075	CASSARINO ALFRED & AUDREY
06-076	GIARD HELEN, ESTATE OF
06-079	NOCCA MARGARET READ & PAUL C
06-080	BRIGGS DAVID W
06-081	GEREHBURG ROLF
06-082	BROWN CRAIG W-2

MAP 5 INSET    MAP 6 INSET

MAP 5    MAP 6  
MAP 9    MAP 10

UPDATES BY  
**CHRISTINE CHAMBERLAIN  
MAPPING**

THESE MAPS ARE FOR ASSESSMENT PURPOSES ONLY. THEY ARE NOT TO BE USED FOR DESCRIPTION, CONVEYANCE, OR DETERMINATION OF LEGAL TITLE. ALL INFORMATION IS SUBJECT TO CHANGE.

**Legend**

- State boundary
- Town boundary
- Road boundary
- Parcel boundary
- Subparcel boundary
- Water boundary
- Right-of-Way
- Common Ownership
- Undeveloped Property
- Surface water
- Match line
- Water boundary

**Zoning Adopted 2006**

- Residential Agricultural District
- Residential District
- Conservation District
- Shoreland Planned Residential District
- Village District
- Neighborhood Commercial District

26 Parcel number (10.2AcS) Subparcel acres  
 (22) Subparcel number (1) Subdivision lot number  
 (19) Historical parcel number 06-086 Parcel number from adjoining sheet  
 10AcS Acres  
 10AcS Acres surveyed  
 10AcC Acres calculated

430000 State plane coordinates  
 26 Parcel number not in grand list

1:2,500

0 400 Feet  
0 200 Meters

TOWN OF  
**BRIDPORT**  
VERMONT  
UPDATED THROUGH APRIL 1, 2022

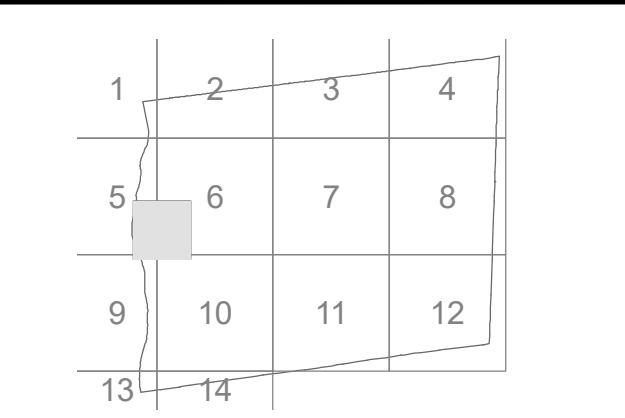

MAP 5 INSET  
&  
MAP 6 INSET